



**AIR MOTORS
CATALOGUE**



modtec
moteurs & solutions pneumatiques

MAX POWER
1300 W
MAX TORQUE
1000 Nm

Powerful and compact, "10" series air motors can develop more than 1200 W and weigh only 2kg for a 60 mm diameter and a total length that can be as short as 155 mm. This makes it one of the highest power-to-weight ratio air motor on the market.

Available in 4 families (Easy, Standard, Heavy and Super heavy duty) with several types of gearboxes and right angle heads, it can develop up to 1000 Nm torque.

The wide variety of flanges and shafts allows the "10" range air motors to be easily fitted to any machine for a wide range of applications.



+ ACCESSORIES FOR THIS MOTOR		Reference
Filtration, pressure Regulation and Lubrication unit (FRL)		ACT07
Safety Air Treatment Box (SAT Box)		ACT18
With Pedal remote control		ACT19
With handle remote control		ACT20
With remote emergency kill switch		ACT25
With remote E-Stop and pedal remote control		ACT21
With remote E-Stop and handle remote control		ACT22
Maintenance kits		
Maintenance kit for "10 XT" series		AC303
Maintenance kit for "10 RV" series		AC308
Maintenance kit for tube free "10 XT" series		AC313
Maintenance kit for tube free "10 RV" series		AC318
Maintenance kit for kit start "10 XT" series		AC323
Maintenance kit for kit start "10 RV" series		AC328
Exhaust collector kit for "10" series		AC340
modex Oil Co-16		ACT49
Control handles		
Safety control handle for non reversible "10" series		AC406
Safety control handle for reversible "10" series		AC404
Progressive control handle for non reversible "10" series		AC400
Progressive control handle for reversible "10" series		AC408
Filters and silencers		
Metallic standard silencer		ACT82
Metallic standard inlet silencer (RV)		ACT81
Plastic standard silencer		ACT52
Plastic standard inlet silencer (RV)		ACT83
Heavy duty silencer		ACT56
Heavy duty inlet silencer (RV)		ACT55
High flow air muffler		ACT58
Exhaust silencer filter		ACT45
Speed control muffler		ACT74

CONNECTION AND LUBRICATION

Min. fittings Ø	Min. pipe Ø		Lubrication (6,2 bars)
	In	Out	
10 mm / 0,4 in	16 mm / 0,5 in	20 mm / 0,8 in	6 drops / minute

CONVERSION TABLE

Watt → Horse power	Newton meter → Pound feet
Watt x 0,001341 = hp	Nm x 0,7376 = lb.ft
Bar → Pound per square Inch	Norme Liter / minute → Standard cubic feet per minute
Bar x 14,5 = psi	NL / min x 0,03531 = scfm
	Millimeter → Inch
	mm x 0,03937 = in
	Kilogram → Pound
	Kg x 2,205 = lb



easy duty

« 10 » serie

MOTORS MTE 10 / NTE 10

POWER 950-1300 W



MTE 10 XT



MTE 10 RV



NTE 10 XT



NTE 10 RV

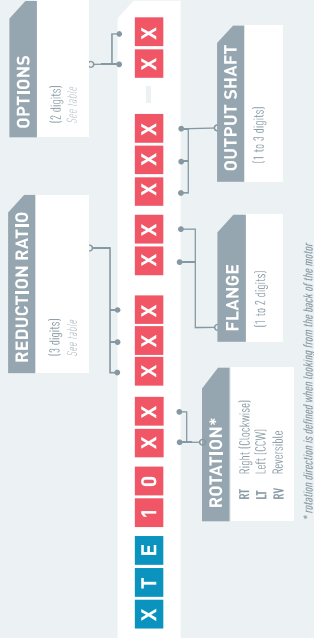

MAXIMUM RADIAL & AXIAL LOAD

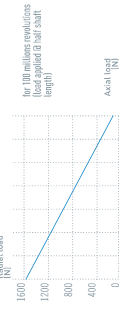

LAYOUT

MTE 10 XT

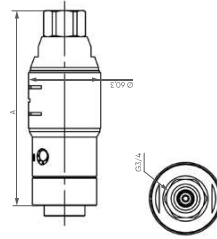

MTE 10 RV

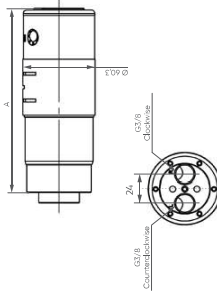

NTE 10 XT

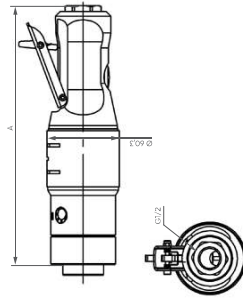

NTE 10 RV

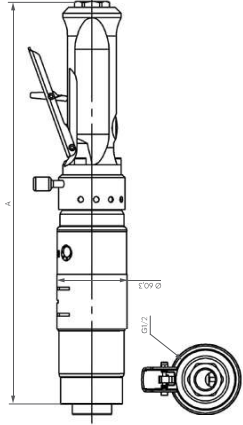

PERFORMANCES MTE / NTE 10

Air motor reference	Reduction ratio	Air supply pressure		Speed (rpm)		Torque (N.m)		Max Power (W)	Air csts (Nl/min)	Dimensions		
		@ max Power	Free	@ max Power	Free	Max (still)	Max (still)			A (mm)	Ø (mm)	Weight (kg)
MTE 10 XT 001	001	6.2 bars	7700	15400	1.4	2.0	1.7	1100	1600	164.1	60.3	1.2
		5 bars	7300	14600	1.1	1.7	1.4	830	1200			
		4 bars	6900	13800	0.82	1.4	1.1	590	1000			
MTE 10 RV 001	001	6.2 bars	8200	16400	1.5	2.2	1.9	1300	1600	154.6	60.3	1.4
		5 bars	7700	15400	1.2	1.8	1.6	1000	1300			
		4 bars	7300	14600	0.91	1.4	1.2	700	1000			
NTE 10 XT 001	001	6.2 bars	9200	18400	1.3	2.0	1.7	1250	1600	216.6	60.3	1.4
		5 bars	8500	17000	1.1	1.7	1.4	940	1300			
		4 bars	7800	15600	0.83	1.3	1.1	680	1000			
NTE 10 RV 001	001	6.2 bars	7200	14400	1.2	1.7	1.5	950	1400	346.1	60.3	2.0
		5 bars	6700	13400	1.0	1.4	1.3	700	1200			
		4 bars	6200	12400	0.78	1.1	0.98	500	1000			

Data indicated in this table have an accuracy of ± 5%

OPTIONS AVAILABLE FOR THE MTE 10

Collected exhaust*	ATEX certification	Left/Right switch	Lubrication free	Kit start	Speed control**	Stainless steel	Code
01	02	03	04	05	06	07	08
09	10	11	12	13	14	15	16
17	18	19	20	21	22	23	24
25	26	27	28	29	30	31	32
33	34	35	36	37	38	39	40

OPTIONS AVAILABLE FOR THE NTE 10 XT

Collected exhaust	ATEX certification	Lubrication free	Kit start	Speed control	Code
01	02	03	04	05	06
07	08	09	10	11	12
13	14	15	16	17	18
19	20	21	22	23	24
25	26	27	28	29	30
31	32	33	34	35	36
37	38	39	40	41	42

POWER, SPEED, TORQUE AND AIR CONSUMPTION GRAPHS

MTE 10 XT

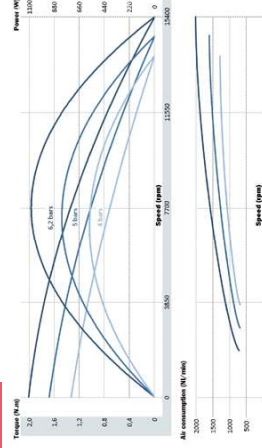

MTE 10 RV

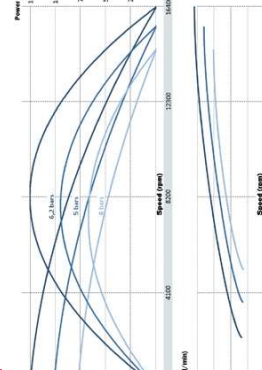

NTE 10 XT

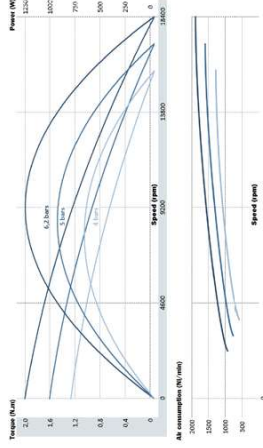

NTE 10 RV

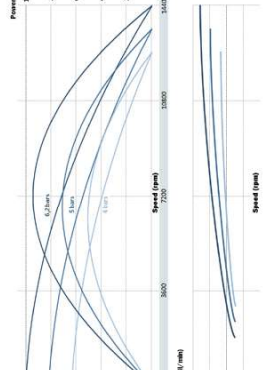

standard duty << 10 >> serie

MOTOR MTS 10

POWER 1100-1300 W



MTS 10 XT



MTS 10 RV

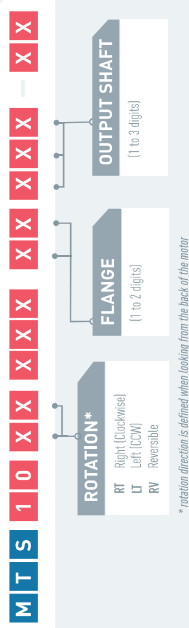

REDUCTION RATIO
(3 digits)
See table

ROTATION*
RT Right (Clockwise)
LT Left (CCW)
RV Reversible

FLANGE
(1 to 2 digits)

OUTPUT SHAFT
(1 to 3 digits)

OPTIONS
(2 digits)
See table

M T S 1 0 X X X X X X X X X X X X

ROTATION*

FLANGE

OUTPUT SHAFT

* rotation direction is defined when looking from the back of the motor

OPTIONS AVAILABLE FOR THIS MOTOR

- Collected exhaust
- ATEX certification
- LED/light switch*
- Lubrication free
- Kit start
- Speed control**

00	01	02	03	04	05	06	07	09	10	12	13	14	15	16	17	18	19	21	22	29	30	31	32
■	■	■	■	■	■	■	■	■	■	■	■	■	■	■	■	■	■	■	■	■	■	■	■

* Reversible motors only
** Non reversible motors only

LAYOUT
MTS 10 XT

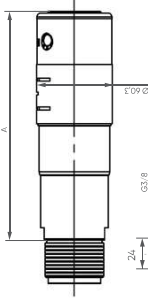

POWER, SPEED, TORQUE AND AIR CONSUMPTION GRAPHS
MTS 10 XT

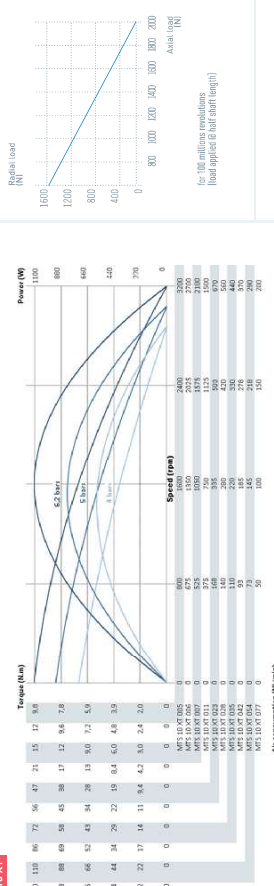

MAXIMUM RADIAL & AXIAL LOAD

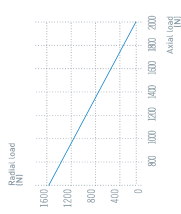

NOTES

MTS 10 RV

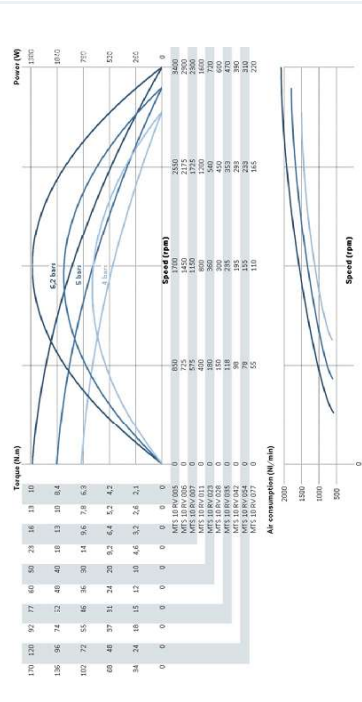

PERFORMANCES

Air motor reference	Reduction ratio	Air supply pressure	Speed (rpm)		Torque (N.m)		Air cons (NI/min)	Max Power (W)	Starting torque	Dimensions		
			@ max Power	Free	@ max Power	Max (statl)				A (mm)	Ø (mm)	Weight (kg)
MTS 10 XT 005	5	6,2 bars	1613	3277	5,5	9,8	1106	8,1	1600	166	60,3	2,0
MTS 10 XT 006	6	4 bars	1243	2842	3,6	6,2	584	5,7	1000	166	60,3	2,0
MTS 10 XT 007	7	5 bars	1347	2694	7,8	12	1106	9,6	1600	166	60,3	2,0
MTS 10 XT 011	11	4 bars	1270	2539	6,3	9,8	834	8,0	1200	166	60,3	2,0
MTS 10 XT 023	23	4 bars	1176	2393	4,7	7,8	590	6,4	1000	166	60,3	2,0
MTS 10 XT 028	28	5 bars	997	1992	1,0	1,2	334	1,0	1200	166	60,3	2,0
MTS 10 XT 035	35	4 bars	939	1877	6,0	10	590	8,2	1000	166	60,3	2,0
MTS 10 XT 042	42	5 bars	738	1475	14	21	1106	18	1600	166	60,3	2,0
MTS 10 XT 054	54	5 bars	695	1360	11	18	834	15	1200	193	60,3	2,3
MTS 10 XT 077	77	4 bars	533	1074	1,4	1,5	584	1,4	1000	193	60,3	2,3
MTS 10 RV 005	5	6,2 bars	1613	3277	5,5	9,8	1106	8,1	1600	156,5	60,3	2,1
MTS 10 RV 006	6	4 bars	1243	2842	3,6	6,2	584	5,7	1000	156,5	60,3	2,1
MTS 10 RV 007	7	5 bars	1347	2694	7,8	12	1106	9,6	1600	156,5	60,3	2,1
MTS 10 RV 011	11	4 bars	1270	2539	6,3	9,8	834	8,0	1200	156,5	60,3	2,1
MTS 10 RV 023	23	4 bars	1176	2393	4,7	7,8	590	6,4	1000	156,5	60,3	2,1
MTS 10 RV 028	28	5 bars	997	1992	1,0	1,2	334	1,0	1200	183,5	60,3	2,4
MTS 10 RV 035	35	4 bars	939	1877	6,0	10	590	8,2	1000	183,5	60,3	2,4
MTS 10 RV 042	42	5 bars	738	1475	14	21	1106	18	1600	183,5	60,3	2,4
MTS 10 RV 054	54	5 bars	695	1360	11	18	834	15	1200	183,5	60,3	2,4
MTS 10 RV 077	77	4 bars	533	1074	1,4	1,5	584	1,4	1000	183,5	60,3	2,4

Data indicated in this table have an accuracy of +/- 5%

www.modtec.fr +33 (0)4 75 40 27 15



MOTOR NTS 10

POWER 950-1250 W



NTS 10 XT

NTS 10 RV

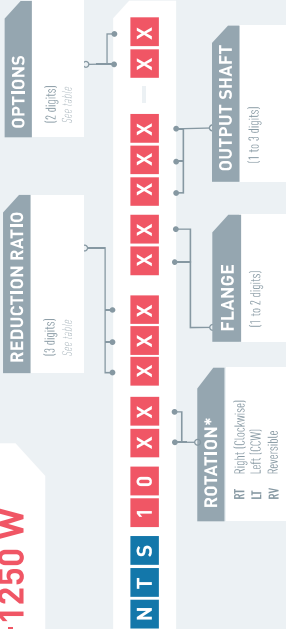

* rotation direction is defined when looking from the back of the motor

PERFORMANCES

Air motor reference	Reduction ratio	Air supply pressure	Speed (rpm)		Torque (N.m)		Max Power (W)	Air cons (NI/min)	Dimensions A (mm)	Dimensions Ø (mm)	Weight (kg)
			@ max Power	Free	@ max Power	Max (static)					
NTS 10 XT 005	5	6,2 bars	1975	3851	6,2	10	1243	1600	218,5	60,3	2,1
NTS 10 XT 006	6	5 bars	1634	3249	5,0	8,1	944	1400	348	60,3	2,1
NTS 10 XT 007	7	4 bars	1481	2962	4,4	7,2	862	1300	348	60,3	2,1
NTS 10 XT 011	11	5 bars	1394	2728	4,8	7,6	1000	1300	375	60,3	2,9
NTS 10 XT 023	23	4 bars	1162	2324	7,7	12	1000	1000	375	60,3	2,9
NTS 10 XT 028	28	4 bars	1070	2140	9,7	14	862	1000	375	60,3	2,9
NTS 10 XT 035	35	5 bars	880	1760	13	21	1243	1600	375	60,3	2,9
NTS 10 XT 042	42	4 bars	817	1622	17	27	936	1600	375	60,3	2,3
NTS 10 XT 054	54	4 bars	712	1434	31	53	936	1600	375	60,3	2,3
NTS 10 XT 077	77	4 bars	596	1192	8	12	1000	1000	375	60,3	2,9
NTS 10 RV 005	5	6,2 bars	1506	3011	6,0	8,4	944	1400	348	60,3	2,7
NTS 10 RV 006	6	5 bars	1304	2608	4,8	6,1	707	1200	348	60,3	2,7
NTS 10 RV 007	7	4 bars	1157	2316	4,2	5,9	512	1000	348	60,3	2,7
NTS 10 RV 011	11	5 bars	1089	2177	4,5	6,4	512	1000	348	60,3	2,7
NTS 10 RV 023	23	4 bars	896	1972	9	13	944	1400	348	60,3	2,7
NTS 10 RV 028	28	4 bars	821	1842	7,3	11	707	1200	375	60,3	2,9
NTS 10 RV 035	35	5 bars	727	1644	11	16	944	1400	375	60,3	2,9
NTS 10 RV 042	42	4 bars	668	1518	13	19	707	1200	375	60,3	2,9
NTS 10 RV 054	54	4 bars	643	1286	11	15	1000	1000	375	60,3	2,9
NTS 10 RV 077	77	4 bars	572	1172	8	12	1000	1000	375	60,3	2,9

Data indicated in this table have an accuracy of +/-5%

OPTIONS AVAILABLE FOR THE NTS 10 XT

Code	00	01	02	04	05	06	07	09	10	13	14	15	18	19	21	22	31	32
Collected exhaust	<input type="checkbox"/>	<input type="checkbox"/>	<input type="checkbox"/>	<input type="checkbox"/>	<input type="checkbox"/>	<input type="checkbox"/>	<input type="checkbox"/>	<input type="checkbox"/>	<input type="checkbox"/>	<input type="checkbox"/>	<input type="checkbox"/>	<input type="checkbox"/>	<input type="checkbox"/>	<input type="checkbox"/>	<input type="checkbox"/>	<input type="checkbox"/>	<input type="checkbox"/>	<input type="checkbox"/>
ATEX certification	<input type="checkbox"/>	<input type="checkbox"/>	<input type="checkbox"/>	<input type="checkbox"/>	<input type="checkbox"/>	<input type="checkbox"/>	<input type="checkbox"/>	<input type="checkbox"/>	<input type="checkbox"/>	<input type="checkbox"/>	<input type="checkbox"/>	<input type="checkbox"/>	<input type="checkbox"/>	<input type="checkbox"/>	<input type="checkbox"/>	<input type="checkbox"/>	<input type="checkbox"/>	<input type="checkbox"/>
Lubrication free	<input type="checkbox"/>	<input type="checkbox"/>	<input type="checkbox"/>	<input type="checkbox"/>	<input type="checkbox"/>	<input type="checkbox"/>	<input type="checkbox"/>	<input type="checkbox"/>	<input type="checkbox"/>	<input type="checkbox"/>	<input type="checkbox"/>	<input type="checkbox"/>	<input type="checkbox"/>	<input type="checkbox"/>	<input type="checkbox"/>	<input type="checkbox"/>	<input type="checkbox"/>	<input type="checkbox"/>
Kit start	<input type="checkbox"/>	<input type="checkbox"/>	<input type="checkbox"/>	<input type="checkbox"/>	<input type="checkbox"/>	<input type="checkbox"/>	<input type="checkbox"/>	<input type="checkbox"/>	<input type="checkbox"/>	<input type="checkbox"/>	<input type="checkbox"/>	<input type="checkbox"/>	<input type="checkbox"/>	<input type="checkbox"/>	<input type="checkbox"/>	<input type="checkbox"/>	<input type="checkbox"/>	<input type="checkbox"/>
Speed control	<input type="checkbox"/>	<input type="checkbox"/>	<input type="checkbox"/>	<input type="checkbox"/>	<input type="checkbox"/>	<input type="checkbox"/>	<input type="checkbox"/>	<input type="checkbox"/>	<input type="checkbox"/>	<input type="checkbox"/>	<input type="checkbox"/>	<input type="checkbox"/>	<input type="checkbox"/>	<input type="checkbox"/>	<input type="checkbox"/>	<input type="checkbox"/>	<input type="checkbox"/>	<input type="checkbox"/>

OPTIONS AVAILABLE FOR THE NTS 10 RV

Code	03	12	16	17	29	30
ATEX certification	<input type="checkbox"/>	<input type="checkbox"/>	<input type="checkbox"/>	<input type="checkbox"/>	<input type="checkbox"/>	<input type="checkbox"/>
Left/Right switch	<input type="checkbox"/>	<input type="checkbox"/>	<input type="checkbox"/>	<input type="checkbox"/>	<input type="checkbox"/>	<input type="checkbox"/>
Lubrication free	<input type="checkbox"/>	<input type="checkbox"/>	<input type="checkbox"/>	<input type="checkbox"/>	<input type="checkbox"/>	<input type="checkbox"/>
Kit start	<input type="checkbox"/>	<input type="checkbox"/>	<input type="checkbox"/>	<input type="checkbox"/>	<input type="checkbox"/>	<input type="checkbox"/>

LAYOUT NTS 10 XT

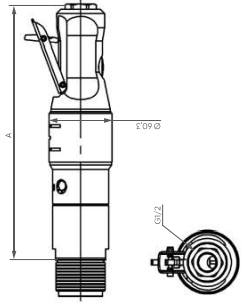

NTS 10 XT

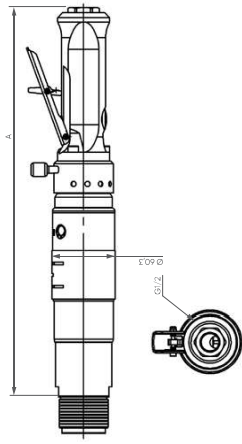

NTS 10 RV

POWER, SPEED, TORQUE AND AIR CONSUMPTION GRAPHS

NTS 10 XT

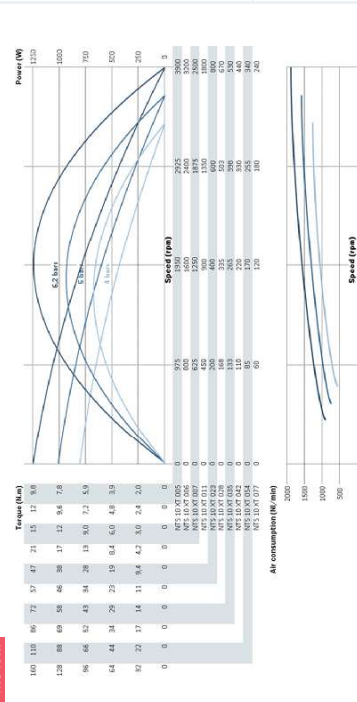

NOTES

NTS 10 RV

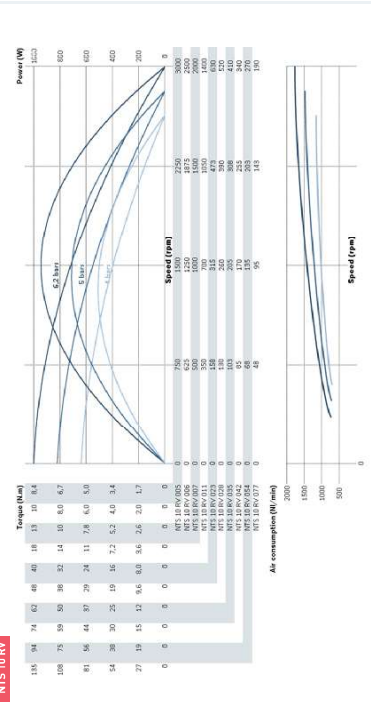

heavy duty << 10 >> serie

MOTOR MTH 10

POWER 1100-1250 W



MTH 10 XT



MTH 10 RV

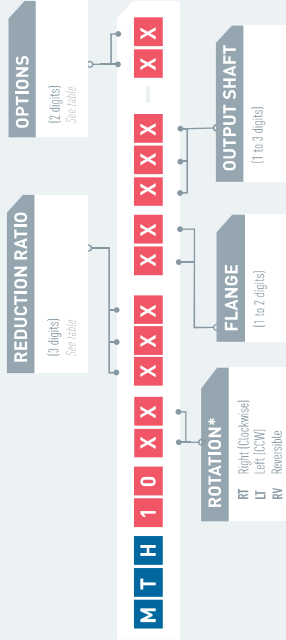

* rotation direction is defined when looking from the back of the motor

PERFORMANCES

Air motor reference	Reduction ratio	Air supply pressure	Speed (rpm)			Torque (N.m)			Max Power (W)	Air cons (NI/min)	Dimensions			
			@ max Power	Free	100%	@ max Power	Max (Istall)	Starting			A (mm)	θ (mm)	Weight (kg)	
MTH 10 XT 096	9,6	6 bars	78	156	132	192	158	1080	1600	1600	260	69	3,4	
			5 bars	73	146	106	130	810	1200	1000	260	69	3,4	
			4 bars	69	139	79	104	577	1000	1000	260	69	3,4	
			3 bars	65	130	77	99	500	1000	1000	260	69	3,4	
MTH 10 XT 115	11,5	6 bars	58	116	95	125	159	1080	1600	1600	260	69	3,4	
			5 bars	55	110	92	121	1080	1600	1600	260	69	3,4	
			4 bars	53	107	91	121	1080	1600	1600	260	69	3,4	
			3 bars	49	96	82	117	910	1200	1000	260	69	3,4	
MTH 10 XT 147	14,7	6 bars	51	102	202	294	241	1080	1600	1600	260	69	3,4	
			5 bars	48	96	162	241	198	810	1200	1000	260	69	3,4
			4 bars	45	91	121	195	159	577	1000	1000	260	69	3,4
			3 bars	42	86	102	188	149	577	1000	1000	260	69	3,4
MTH 10 RV 096	9,6	6 bars	85	170	140	180	158	1243	1600	1600	250,5	69	3,4	
			5 bars	80	160	110	144	127	973	1300	1000	250,5	69	3,4
			4 bars	74	149	85	111	98	662	1000	1000	250,5	69	3,4
			3 bars	71	142	168	215	190	1243	1600	1600	250,5	69	3,4
MTH 10 RV 115	11,5	6 bars	67	134	102	133	172	1080	1600	1600	250,5	69	3,4	
			5 bars	62	124	102	133	172	1080	1600	1600	250,5	69	3,4
			4 bars	60	121	102	133	172	1080	1600	1600	250,5	69	3,4
			3 bars	56	111	214	275	242	1243	1600	1600	250,5	69	3,4
MTH 10 RV 147	14,7	6 bars	52	105	168	220	194	1243	1600	1600	250,5	69	3,4	
			5 bars	52	105	168	220	194	1243	1600	1600	250,5	69	3,4
			4 bars	49	98	130	169	149	662	1000	1000	250,5	69	3,4
			3 bars	46	94	130	169	149	662	1000	1000	250,5	69	3,4

Data indicated in this table have an accuracy of ±5%

OPTIONS AVAILABLE FOR THIS MOTOR

Collected exhaust	00	01	02	03	04	05	06	07	09	10	12	13	14	15	16	17	18	19	21	22	29	30	31	32	
ATEX certification																									
Left/Right switch*																									
Lubrication free																									
Kit start																									
Speed control**																									
Code																									

* Reversible motors only ** Non reversible motors only

LAYOUT

MTH 10 XT

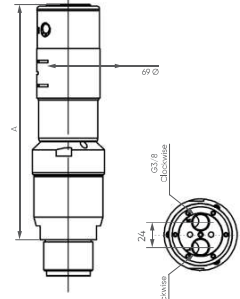
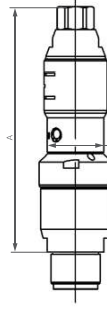

POWER, SPEED, TORQUE AND AIR CONSUMPTION GRAPHS

MTH 10 XT

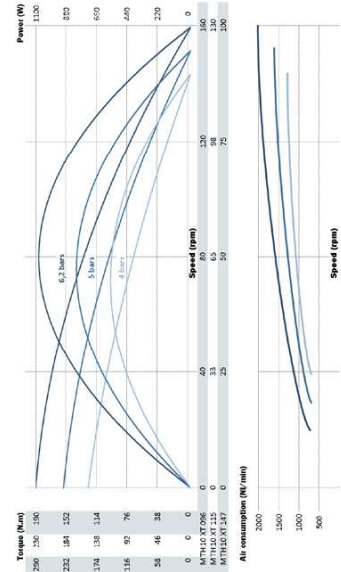

MAXIMUM RADIAL & AXIAL LOAD

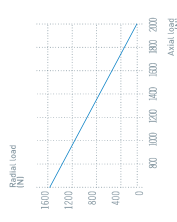

NOTES

MTH 10 RV

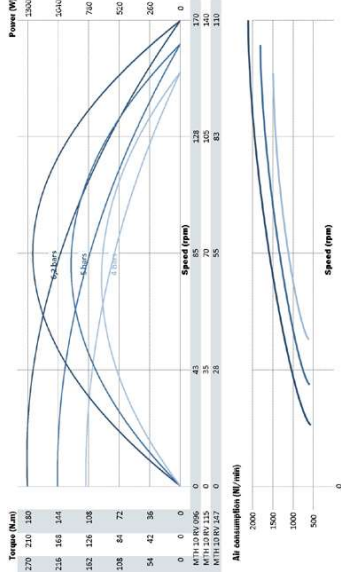

heavy duty

<< 10 >> serie

MOTOR NTH 10

POWER 800-1150 W



NTH 10 XT

NTH 10 RV

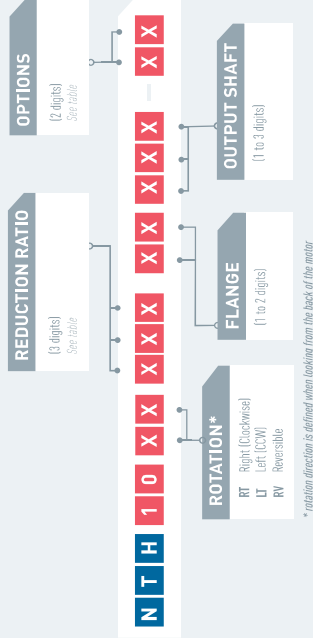

* rotation direction is defined when looking from the back of the motor

OPTIONS AVAILABLE FOR THE NTH10XT

Collected exhaust	<input type="checkbox"/>	00	01	02	04	05	06	07	09	10	13	14	15	18	19	21	22	31	32
ATEX certification	<input type="checkbox"/>																		
Lubrication free	<input type="checkbox"/>																		
Kit start	<input type="checkbox"/>																		
Speed control	<input type="checkbox"/>																		
Code		00	01	02	04	05	06	07	09	10	13	14	15	18	19	21	22	31	32

OPTIONS AVAILABLE FOR THE NTH10RV

ATEX certification	<input type="checkbox"/>	03	12	16	17	29	30
Left/right switch	<input type="checkbox"/>						
Lubrication free	<input type="checkbox"/>						
Kit start	<input type="checkbox"/>						
Code		03	12	16	17	29	30

LAYOUT

NTH 10 XT

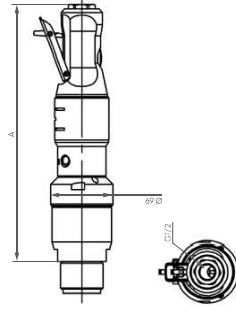

NTH 10 RV

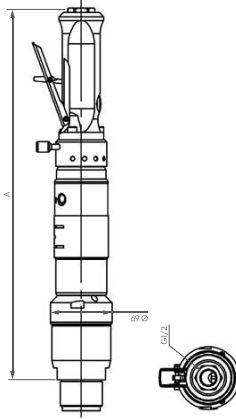

PERFORMANCES

Air motor reference	Reduction ratio	Air supply pressure	Speed (rpm)			Torque (N.m)			Max Power (W)	Air cons (NI/min)	Dimensions		
			@ max Power	Free	@ max Power	Max (stall)	Starting torque	A (mm)			Ø (mm)	Weight (kg)	
NTH 10 XT 096	9,6	6 bars	90	181	122	191	157	1155	1600	1600	312,5	69	4,0
			85	170	100	157	129	890	1300	641	312,5	69	4,0
			81	161	76	127	104	641	1000	641	312,5	69	4,0
			75	152	46	76	58	195	1600	641	312,5	69	4,0
NTH 10 XT 115	11,5	6 bars	67	134	91	152	124	641	1000	1000	312,5	69	4,0
			67	134	91	152	124	641	1000	1000	312,5	69	4,0
			57	118	186	292	239	1155	1600	1600	312,5	69	4,0
			56	111	153	240	197	890	1300	641	312,5	69	4,0
NTH 10 XT 147	14,7	5 bars	53	105	116	193	158	641	1000	1000	442	69	3,7
			53	105	116	193	158	641	1000	1000	442	69	3,7
			48	97	156	217	191	787	1400	1400	442	69	3,7
			46	91	127	175	154	604	1200	1200	442	69	3,7
NTH 10 RV 096	9,6	6 bars	74	147	102	162	125	787	1600	1600	442	69	3,7
			70	139	83	114	101	604	1200	1200	442	69	3,7
			65	129	64	88	77	434	1000	1000	442	69	3,7
			62	123	62	171	150	797	1400	1400	442	69	3,7
NTH 10 RV 115	11,5	6 bars	56	108	77	105	93	641	1000	1000	442	69	3,7
			56	108	77	105	93	641	1000	1000	442	69	3,7
			48	97	156	217	191	787	1400	1400	442	69	3,7
			46	91	127	175	154	604	1200	1200	442	69	3,7
NTH 10 RV 147	14,7	5 bars	74	147	102	162	125	787	1600	1600	442	69	3,7
			70	139	83	114	101	604	1200	1200	442	69	3,7
			65	129	64	88	77	434	1000	1000	442	69	3,7
			62	123	62	171	150	797	1400	1400	442	69	3,7
NTH 10 RV 169	16,9	5 bars	40	74	112	154	136	434	1000	1000	442	69	3,7
			40	74	112	154	136	434	1000	1000	442	69	3,7
			37	74	112	154	136	434	1000	1000	442	69	3,7
			35	70	215	300	264	787	1400	1400	442	69	3,7
NTH 10 RV 202	20,2	5 bars	33	66	175	241	212	604	1200	1200	442	69	3,7
			31	61	135	185	163	434	1000	1000	442	69	3,7

Data indicated in this table have an accuracy of +/- 5%

MAXIMUM RADIAL & AXIAL LOAD

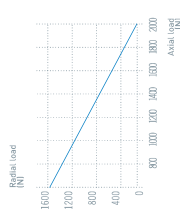

POWER, SPEED, TORQUE AND AIR CONSUMPTION GRAPHS

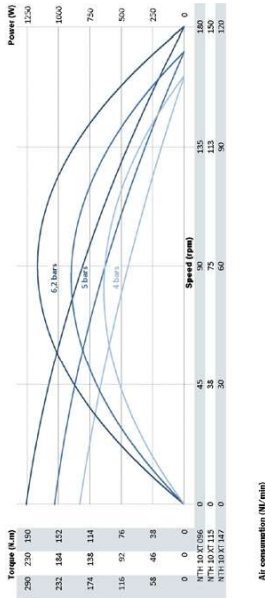

Power (W)	1250	1000	750	500	250	150	100	50	0
Torque (N.m)	250	230	150	100	50	0	0	0	0
Air consumption (NI/min)	1500	1300	900	600	300	150	100	50	0

NOTES

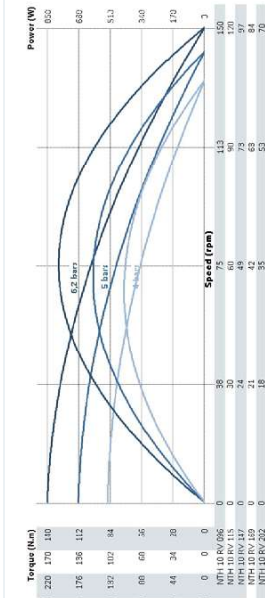

Power (W)	600	450	300	150	75	37	18	9	0
Torque (N.m)	300	250	170	110	55	27	13	6	0
Air consumption (NI/min)	900	750	500	350	175	87	43	21	0



MOTOR MTZ 10

POWER 1100-1250 W



MTZ 10 XT



MTZ 10 RV

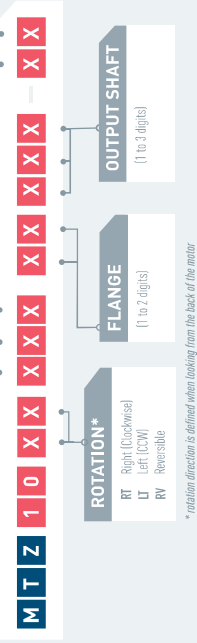

OPTIONS AVAILABLE FOR THIS MOTOR

Collected exhaust	00	01	02	03	04	05	06	07	09	10	11	12	13	14	15	16	17	18	19	21	22	23	27	28	29	30	31	32	36	37	
ATEX certification																															
Left/Right switch*																															
Lubrication free																															
Kit start																															
Speed control**																															
Stainless steel																															

* Reversible motors only ** Non reversible motors only

LAYOUT

MTZ 10 XT

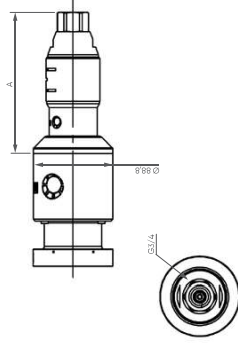

MTZ 10 RV

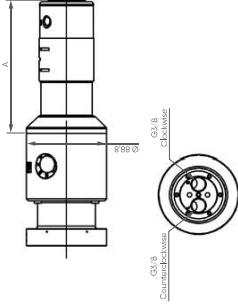

POWER, SPEED, TORQUE AND AIR CONSUMPTION GRAPHS

MTZ 10 XT

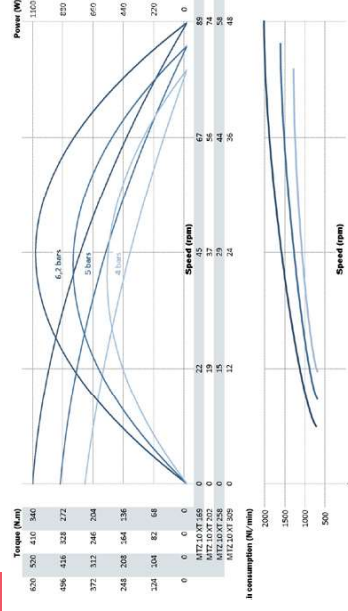

MTZ 10 RV

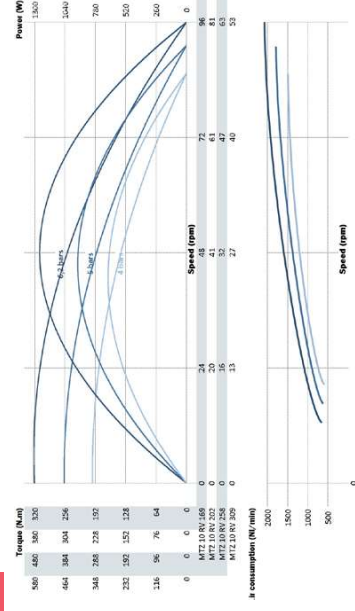

MAXIMUM RADIAL & AXIAL LOAD

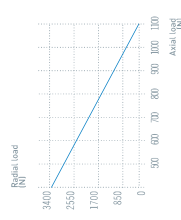

NOTES

Air motor reference	MTZ 10 XT				MTZ 10 RV			
	Reduction ratio	Air supply pressure	Speed (rpm)	Torque (N.m)	Max Power (W)	Air cons (l/min)	Dimensions	Weight (kg)
MTZ 10 XT 169	169	6 bars	44	338	1080	1600	158,2	4,5
MTZ 10 XT 202	202	4 bars	39	224	577	1000	158,2	4,5
MTZ 10 XT 258	258	5 bars	37	312	1080	1600	158,2	4,5
MTZ 10 XT 309	309	4 bars	29	167	577	1000	158,2	4,5
		6 bars	29	335	1080	1600	158,2	4,5
		5 bars	27	284	810	1200	158,2	4,5
		4 bars	24	172	577	1000	158,2	4,5
		6 bars	24	341	1080	1600	158,2	4,5
		5 bars	23	45	810	1200	158,2	4,5
		4 bars	22	43	577	1000	158,2	4,5
MTZ 10 RV 169	169	6 bars	49	316	1243	1600	148,7	4,6
MTZ 10 RV 202	202	4 bars	42	195	662	1000	148,7	4,6
MTZ 10 RV 258	258	5 bars	38	379	1243	1500	148,7	4,6
MTZ 10 RV 309	309	4 bars	30	174	662	1000	148,7	4,6
		6 bars	30	374	1243	1500	148,7	4,6
		5 bars	28	298	810	1200	148,7	4,6
		4 bars	24	172	662	1000	148,7	4,6
		6 bars	23	357	1243	1500	148,7	4,6
		5 bars	23	46	810	1200	148,7	4,6

Data indicated in this table have an accuracy of ± 5%



motors & solutions pneumatiques

super heavy duty

<< 10 >> serie

MOTOR NTZ 10

POWER 800-1150 W



NTZ 10 XT

NTZ 10 RV

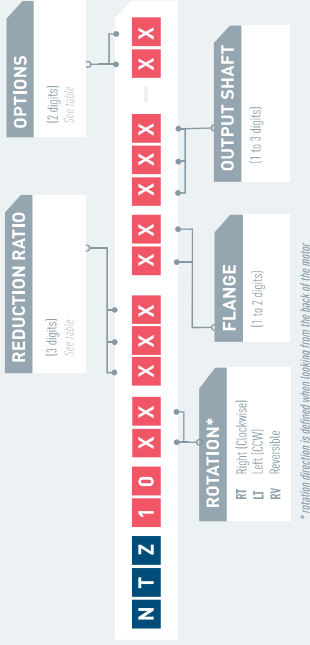

OPTIONS AVAILABLE FOR THE NTZ10XT

Collected exhaust	<input type="checkbox"/>	00	01	02	04	05	06	07	09	10	13	14	15	18	19	21	22	31	32
ATEX certification	<input type="checkbox"/>																		
Lubrication free	<input type="checkbox"/>																		
Kit start	<input type="checkbox"/>																		
Speed control	<input type="checkbox"/>																		
Code		00	01	02	04	05	06	07	09	10	13	14	15	18	19	21	22	31	32

OPTIONS AVAILABLE FOR THE NTZ10RV

ATEX certification	<input type="checkbox"/>	03	12	16	17	29	30
Left/Right switch	<input type="checkbox"/>						
Lubrication free	<input type="checkbox"/>						
Kit start	<input type="checkbox"/>						
Code		03	12	16	17	29	30

LAYOUT

NTZ 10 XT

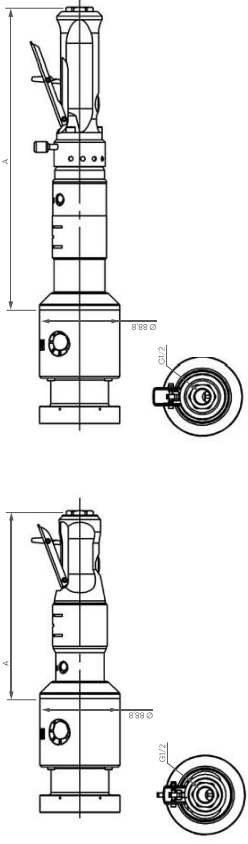

MAXIMUM RADIAL & AXIAL LOAD

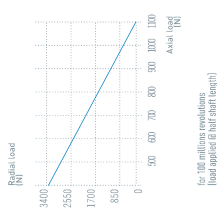

POWER, SPEED, TORQUE AND AIR CONSUMPTION GRAPHS

NTZ 10 XT

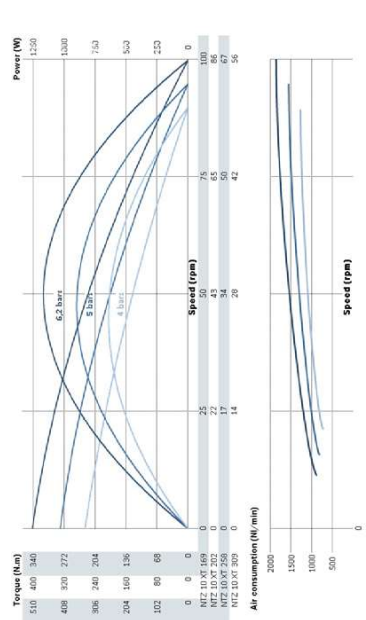

NOTES

NTZ 10 RV

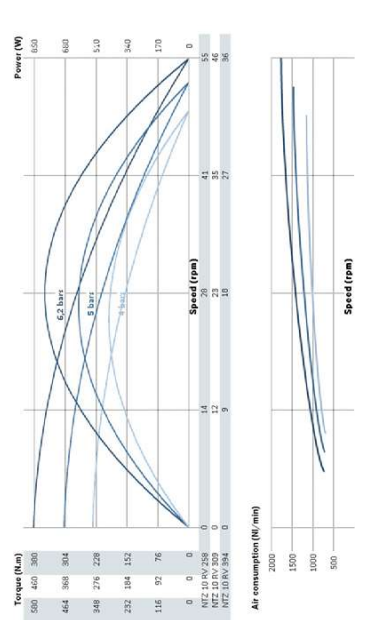

PERFORMANCES

Air motor reference	Reduction ratio	Air supply pressure	Speed (rpm)			Torque (N.m)			Max Power (W)	Air cons (Nl/min)	Dimensions A (mm)	Dimensions Ø (mm)	Weight (kg)
			@ max Power	Free	56	Max (lstatl)	Starting torque						
NTZ 10 XT 169	169	6 bars	51	103	214	336	276	1155	1600	210,7	88,8	4,8	
NTZ 10 XT 202	202	4 bars	46	92	184	222	182	641	1000	210,7	88,8	4,8	
NTZ 10 XT 258	258	5 bars	43	86	171	213	240	1095	1600	210,7	88,8	4,8	
NTZ 10 XT 309	309	4 bars	38	76	160	267	219	641	1000	210,7	88,8	4,8	
NTZ 10 XT 394	394	6 bars	34	67	327	513	421	1155	1600	210,7	88,8	4,8	
NTZ 10 XT 468	468	5 bars	32	63	268	421	346	890	1300	210,7	88,8	4,8	
NTZ 10 XT 564	564	4 bars	28	50	322	415	502	1155	1600	210,7	88,8	4,8	
NTZ 10 XT 672	672	5 bars	26	53	322	505	414	890	1300	210,7	88,8	4,8	
NTZ 10 XT 800	800	4 bars	25	50	244	407	334	641	1000	210,7	88,8	4,8	
NTZ 10 RV 258	258	6 bars	27	55	274	367	336	787	1400	340,2	88,8	5,4	
NTZ 10 RV 309	309	4 bars	24	48	172	236	208	434	1000	340,2	88,8	5,4	
NTZ 10 RV 394	394	5 bars	22	43	327	458	403	787	1400	340,2	88,8	5,4	
NTZ 10 RV 468	468	4 bars	20	40	218	367	323	604	1200	340,2	88,8	5,4	
NTZ 10 RV 564	564	5 bars	18	30	418	582	519	787	1400	340,2	88,8	5,4	
NTZ 10 RV 672	672	2 bars	17	34	340	468	412	604	1200	340,2	88,8	5,4	
NTZ 10 RV 800	800	1 bars	16	32	262	340	317	434	1000	340,2	88,8	5,4	

Data indicated in this table have an accuracy of ± 5%



standard duty << 10 >> serie

MOTOR MRS 10

POWER 1000-1200 W



MRS 10 XT

MRS 10 RV

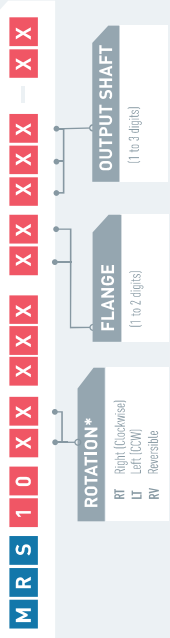

* rotation direction is defined when looking from the back of the motor

OPTIONS AVAILABLE FOR THIS MOTOR

Collected exhaust	00	01	02	03	04	05	06	07	09	10	12	13	14	15	16	17	18	19	21	22	29	30	31	32	
ATEX certification																									
Left/Right switch*																									
Lubrication free																									
Kit start																									
Speed control**																									
Code																									

* Reversible motors only ** Non reversible motors only

LAYOUT

MRS 10 XT

MRS 10 RV

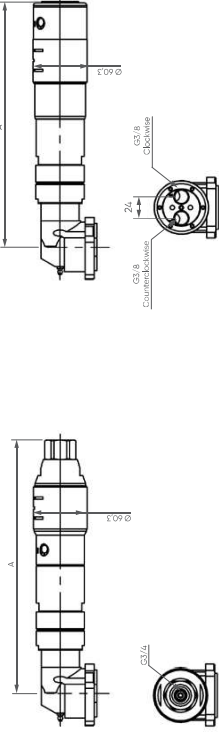

PERFORMANCES

MRS 10 XT Air motor reference	Reduction ratio	Air supply pressure	Speed (rpm)		Torque (N.m)		Max Power (W)	Air cons (NI/min)	Dimensions		
			@ max Power	Free	@ max Power	Max (stall)			A (mm)	Ø (mm)	Weight (kg)
MRS 10 XT 006	6	6,2 bars	1190	2381	7,9	12	987	1600	258	60,3	3,1
MRS 10 XT 008	8	5 bars	1106	2213	6,4	10	736	1000	258	60,3	3,1
MRS 10 XT 010	10	4 bars	1028	2057	5,0	7,9	636	1200	258	60,3	3,1
MRS 10 XT 014	14	5 bars	873	1807	7,2	9,8	736	1200	258	60,3	3,1
MRS 10 XT 031	31	6,2 bars	658	1717	6,0	9,5	538	1000	285	60,3	3,4
MRS 10 XT 037	37	6,2 bars	779	1559	12	18	997	1600	285	60,3	3,4
MRS 10 XT 047	47	5 bars	724	1469	9,7	15	736	1200	285	60,3	3,4
MRS 10 XT 056	56	5 bars	724	1469	9,7	15	736	1200	285	60,3	3,4
MRS 10 XT 071	71	6,2 bars	544	1088	17	26	997	1600	285	60,3	3,4
MRS 10 XT 086	86	6,2 bars	506	1011	14	22	736	1200	285	60,3	3,4
MRS 10 XT 097	97	4 bars	470	940	11	17	538	1000	285	60,3	3,4
MRS 10 XT 047	47	5 bars	207	414	4,6	6,9	997	1600	285	60,3	3,4
MRS 10 XT 056	56	5 bars	192	385	5,7	8,4	736	1200	285	60,3	3,4
MRS 10 XT 071	71	6,2 bars	162	328	5,8	8,9	538	1000	285	60,3	3,4
MRS 10 XT 086	86	6,2 bars	151	302	4,7	7,3	302	1200	285	60,3	3,4
MRS 10 XT 097	97	4 bars	140	281	3,7	5,8	48	1000	285	60,3	3,4
MRS 10 XT 047	47	5 bars	136	271	7,0	10,6	997	1600	285	60,3	3,4
MRS 10 XT 056	56	5 bars	119	234	4,4	7,0	538	1000	285	60,3	3,4
MRS 10 XT 071	71	6,2 bars	106	213	8,9	13,5	997	1600	285	60,3	3,4
MRS 10 XT 086	86	6,2 bars	99	198	7,1	11,2	736	1200	285	60,3	3,4
MRS 10 XT 097	97	4 bars	92	184	5,6	8,9	538	1000	285	60,3	3,4

MRS 10 RV Air motor reference	Reduction ratio	Air supply pressure	Speed (rpm)		Torque (N.m)		Max Power (W)	Air cons (NI/min)	Dimensions		
			@ max Power	Free	@ max Power	Max (stall)			A (mm)	Ø (mm)	Weight (kg)
MRS 10 RV 006	6	6,2 bars	1233	2465	9,4	13	1218	1600	248,5	60,3	3,3
MRS 10 RV 008	8	5 bars	1158	2317	7,6	11	916	1300	248,5	60,3	3,3
MRS 10 RV 010	10	4 bars	1029	2058	5,8	8,3	661	1000	248,5	60,3	3,3
MRS 10 RV 014	14	5 bars	909	1818	6,9	10	661	1000	248,5	60,3	3,3
MRS 10 RV 031	31	6,2 bars	807	1615	14	20	1218	1600	275,5	60,3	3,6
MRS 10 RV 037	37	6,2 bars	759	1517	12	17	916	1300	275,5	60,3	3,6
MRS 10 RV 047	47	5 bars	713	1455	9,9	13	661	1000	275,5	60,3	3,6
MRS 10 RV 056	56	5 bars	665	1393	11	16	538	1000	275,5	60,3	3,6
MRS 10 RV 071	71	6,2 bars	530	1059	17	24	916	1300	275,5	60,3	3,6
MRS 10 RV 086	86	6,2 bars	498	996	13	18	661	1000	275,5	60,3	3,6
MRS 10 RV 097	97	4 bars	470	940	11	17	538	1000	275,5	60,3	3,6
MRS 10 RV 047	47	5 bars	221	453	28	42	916	1300	275,5	60,3	3,6
MRS 10 RV 056	56	5 bars	201	403	43	62	55	916	275,5	60,3	3,6
MRS 10 RV 071	71	6,2 bars	189	379	33	48	42	661	275,5	60,3	3,6
MRS 10 RV 086	86	6,2 bars	158	316	55	80	70	538	275,5	60,3	3,6
MRS 10 RV 097	97	4 bars	149	297	43	61	54	661	275,5	60,3	3,6
MRS 10 RV 047	47	5 bars	140	281	83	117	103	1218	275,5	60,3	3,6
MRS 10 RV 056	56	5 bars	132	264	64	95	84	916	275,5	60,3	3,6
MRS 10 RV 071	71	6,2 bars	110	220	106	149	132	1218	275,5	60,3	3,6
MRS 10 RV 086	86	6,2 bars	103	207	85	121	107	916	275,5	60,3	3,6
MRS 10 RV 097	97	4 bars	97	195	65	93	82	661	275,5	60,3	3,6

Data indicated in this table have an accuracy of ± 5%

www.moddec.fr +33 (0)4 75 40 27 15

MAXIMUM RADIAL & AXIAL LOAD

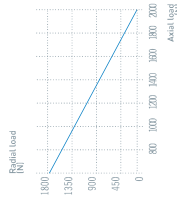

For MRS 10 RV applications
Load applied on ball (1 length)

POWER, SPEED, TORQUE AND AIR CONSUMPTION GRAPHS

MRS 10 XT

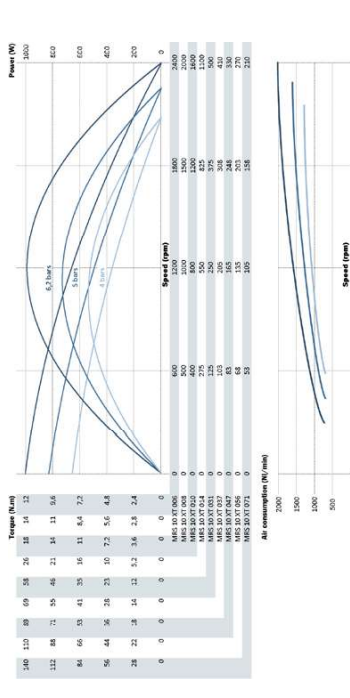

MRS 10 RV

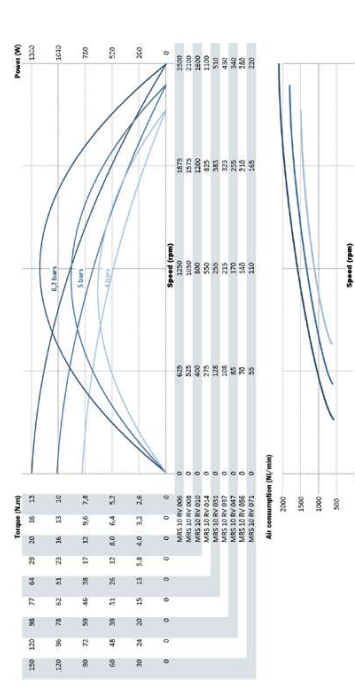

NOTES



moddec
motors & solutions pneumatics

MOTOR MRH 10

POWER 1000-1150 W



MRH 10 XT



MRH 10 RV

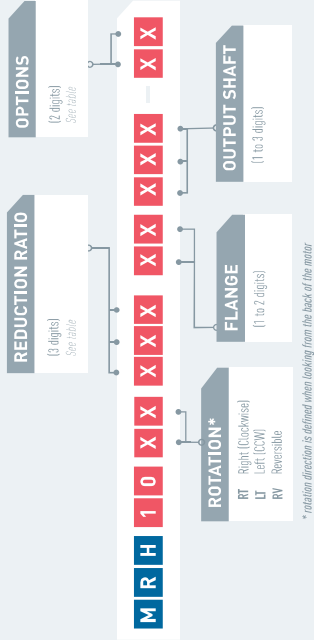

OPTIONS AVAILABLE FOR THIS MOTOR

- Collected exhaust
- ATEX certification
- Left/right switch*
- Lubrication line
- Kit start
- Speed control**

00	01	02	03	04	05	06	07	09	10	12	13	14	15	16	17	18	19	21	22	29	30	31	32
----	----	----	----	----	----	----	----	----	----	----	----	----	----	----	----	----	----	----	----	----	----	----	----

* Reversible motors only ** Non reversible motors only

LAYOUT

MRH 10 XT

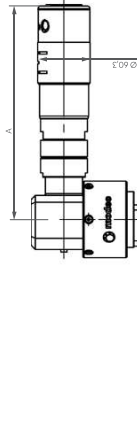
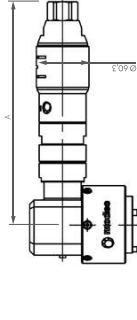

CS-B Counterflange

CS-A Counterflange

POWER, SPEED, TORQUE AND AIR CONSUMPTION GRAPHS

MRH 10 XT

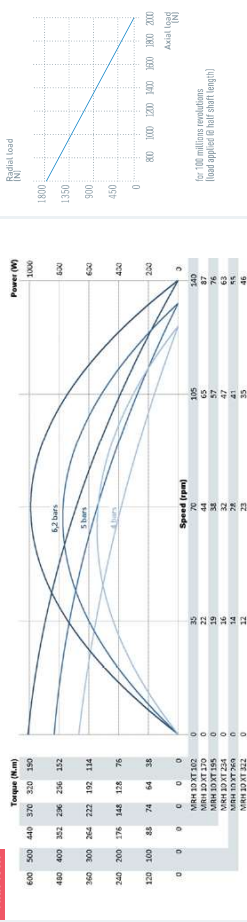

NOTES

MRH 10 RV

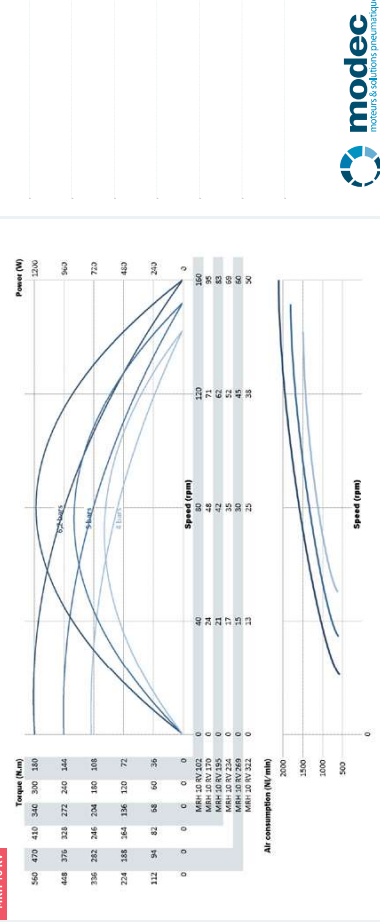

PERFORMANCES

Air motor reference	Reduction ratio	Air supply pressure	Speed (rpm)		Torque (N.m)		Max Power (W)	Air cons (Nl/min)	Dimensions	
			@ max Power	Free	Max (Istall)	Starting torque			A (mm)	Ø (mm)
MRH 10 XT 102	102	6,2 bars	72	145	191	157	978	1600	258	69
MRH 10 XT 170	170	4 bars	64	179	107	130	765	1000	282	69
MRH 10 XT 195	195	5 bars	66	184	107	130	765	1000	282	69
MRH 10 XT 234	234	4 bars	30	60	245	361	765	1000	282	69
MRH 10 XT 269	269	6,2 bars	28	55	399	503	978	1600	282	69
MRH 10 XT 322	322	4 bars	22	43	338	408	978	1000	282	69
MRH 10 RV										
MRH 10 RV 102	102	6,2 bars	79	158	142	179	1163	1600	248,5	69
MRH 10 RV 170	170	5 bars	69	138	86	110	835	1000	272,5	69
MRH 10 RV 195	195	6,2 bars	49	95	235	261	1172	1600	272,5	69
MRH 10 RV 234	234	4 bars	39	78	213	274	870	1000	272,5	69
MRH 10 RV 269	269	5 bars	36	73	164	210	1185	1000	272,5	69
MRH 10 RV 322	322	6,2 bars	25	50	447	563	1172	1000	272,5	69

Data indicated in this table have an accuracy of ± 5%

super heavy duty

<< 10 >> serie

MOTOR MRZ 10

POWER 1050-1200 W



MRZ 10 XT



MRZ 10 RV

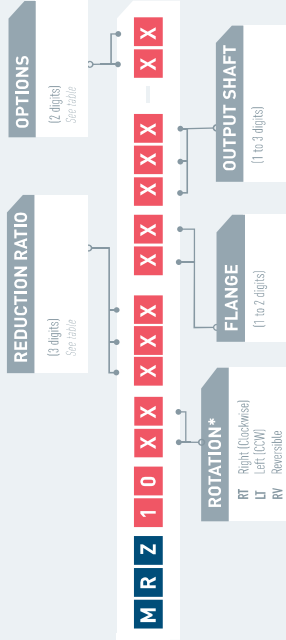

* rotation direction is defined when looking from the back of the motor

PERFORMANCES

Air motor reference	Reduction ratio	Air supply pressure	Speed (rpm)			Torque (N.m)			Max Power (W)	Air cons (NI/min)	Dimensions A (mm)	Dimensions θ (mm)	Weight (kg)	
			@ max Power	Free	Free	@ max Power	Max (stall)	Starting torque						
MRZ 10 XT 338	338	6,2 bars	22	44	451	677	555	1046	1600	1600	393,8	88,8	11,5	
			21	42	369	560	459	802	1200	1000				
			20	39	279	448	367	577	1000					
			19	38	232	471	625	1046	1600					
MRZ 10 XT 399	399	6,2 bars	17	33	330	529	433	577	1000	1000	393,8	88,8	11,5	
			16	32	289	559	487	625	1000					
			15	29	689	1033	847	1046	1600					
			14	27	563	855	701	802	1200					
MRZ 10 XT 516	516	5 bars	13	26	426	684	561	677	1000	1000	393,8	88,8	11,5	
			12	25	369	701	577	625	1000					
			11	24	312	718	588	642	1000					
			10	23	255	735	605	659	1000					
MRZ 10 RV	Air motor reference	Reduction ratio	Air supply pressure	Speed (rpm)			Torque (N.m)			Max Power (W)	Air cons (NI/min)	Dimensions A (mm)	Dimensions θ (mm)	Weight (kg)
				@ max Power	Free	Free	@ max Power	Max (stall)	Starting torque					
MRZ 10 RV 338	338	6,2 bars	21	45	487	652	554	1213	1600	1600	384,3	88,8	10,7	
			20	44	446	674	573	573	1300	1300				
			19	42	388	390	343	674	1600	1600				
			18	41	581	746	657	1243	1600	1600				
MRZ 10 RV 399	399	6,2 bars	17	39	357	546	443	577	1000	1000	384,3	88,8	10,7	
			16	38	316	579	497	625	1000	1000				
			15	36	751	966	850	1243	1600	1600				
			14	35	694	983	867	1243	1600	1600				
MRZ 10 RV 516	516	5 bars	15	30	592	775	682	923	1300	1300	384,3	88,8	10,7	
			14	28	456	596	524	662	1000	1000				

Data indicated in this table have an accuracy of +/- 5%

OPTIONS AVAILABLE FOR THIS MOTOR

Collected exhaust	00	01	02	03	04	05	06	07	09	10	12	13	14	15	16	17	18	19	21	22	29	30	31	32	
ATEX certification																									
Left/right switch*																									
Lubrication free																									
Kit start																									
Speed control**																									
Code																									

* Reversible motors only ** Non reversible motors only

LAYOUT

MRZ 10 XT

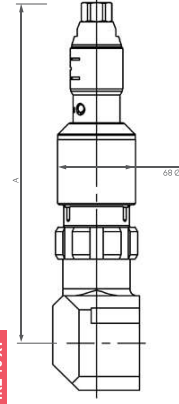

MRZ 10 RV

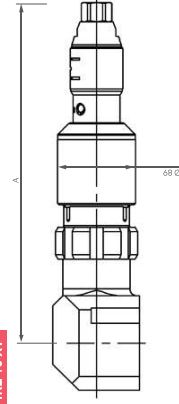

POWER, SPEED, TORQUE AND AIR CONSUMPTION GRAPHS

MRZ 10 XT

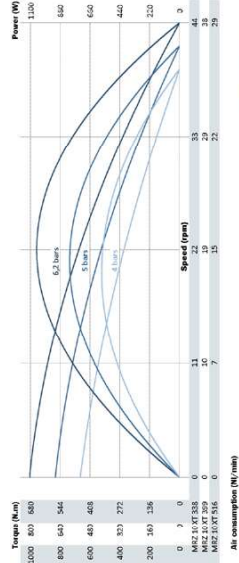

NOTES

MRZ 10 RV

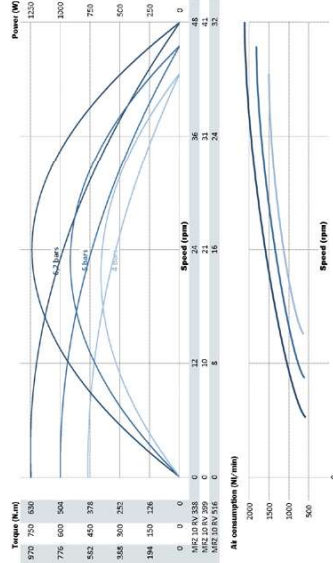

MAXIMUM RADIAL & AXIAL LOAD

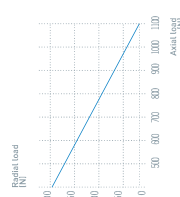

For MRZ 10 XT 516
 Load applied to shaft (1 length)



super heavy duty

<< 10 >> serie

MOTOR NRZ 10

POWER 800-1150 W



NRZ 10 XT



NRZ 10 RV

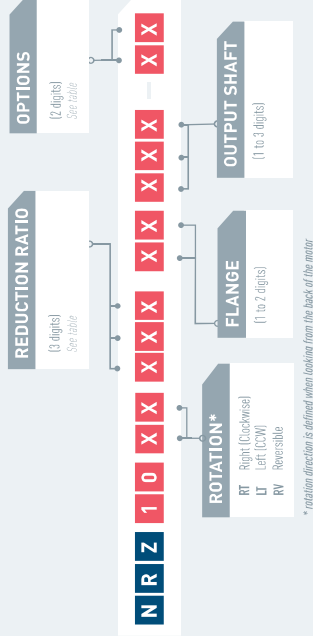

OPTIONS AVAILABLE FOR THE NRZ10XT

Collected exhaust	05	06	07	09	10	13	14	15	18	19	21	22	31	32
ATEX certification														
Lubrication free														
Speed control														
Code														

OPTIONS AVAILABLE FOR THE NRZ10RV

ATEX certification	03	12	16	17	29	30
Left/right switch						
Lubrication free						
Kit start						
Code						

LAYOUT

NRZ 10 XT

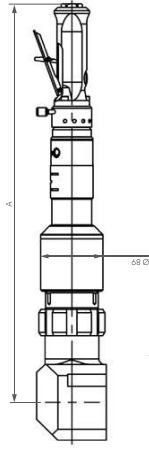
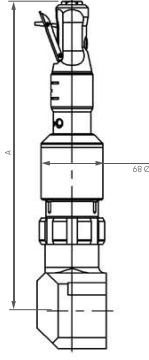

POWER, SPEED, TORQUE AND AIR CONSUMPTION GRAPHS

NRZ 10 XT

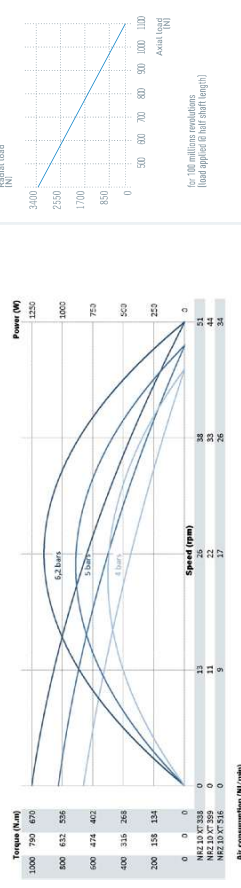

MAXIMUM RADIAL & AXIAL LOAD

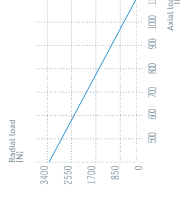

NOTES

PERFORMANCES

Air motor reference	Reduction ratio	Air supply pressure	Speed (rpm)			Torque (N.m)			Air cons (NI/min)			Dimensions	
			@ max Power	Free	Free	@ max Power	Max (Istart)	Starting torque	Max Power (W)	Air cons (NI/min)	A (mm)	θ (mm)	Weight (kg)
NRZ 10 XT 338	338	6,2 bars	26	51	427	672	551	1150	1600	446,2	88,8	10,5	10,5
NRZ 10 XT 399	399	6,2 bars	27	44	316	465	537	892	1300	446,2	88,8	10,5	10,5
NRZ 10 XT 516	516	6,2 bars	17	34	652	1027	842	1150	1600	446,2	88,8	10,5	10,5
NRZ 10 RV		6,2 bars	16	32	538	848	695	892	1300	575,7	88,8	11,2	11,2
NRZ 10 RV 516	516	6,2 bars	16	32	538	848	695	892	1300	575,7	88,8	11,2	11,2
NRZ 10 RV 618	618	6,2 bars	11	23	654	916	806	785	1400	575,7	88,8	11,2	11,2
NRZ 10 RV 618	618	4 bars	10	20	413	565	497	436	1000	575,7	88,8	11,2	11,2

Data indicated in this table have an accuracy of ± 5%



FLANGES & SHAFTS

Coupling the motor on your machine is as critical as choosing the right motor ! With Modec, no need to modify your machine to make it compliant with the motor. We offer a wide choice of flanges and shafts so that you can find the ones that match your need. In case you don't find the right one, we can design and manufacture specific flanges and shafts on request.

FLANGES & SHAFTS GROUP I

MTE 05 MTS 05

GROUP I FLANGE AA

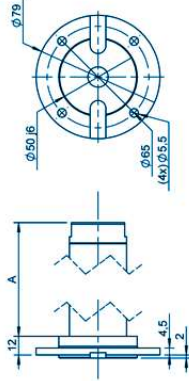

GROUP I FLANGE B

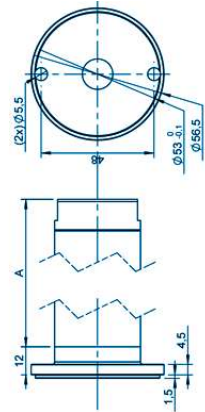

GROUP I FLANGE P

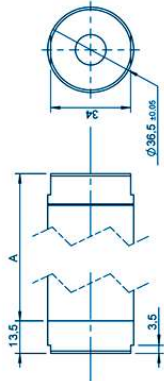

GROUP I FLANGE S - IEC63B14

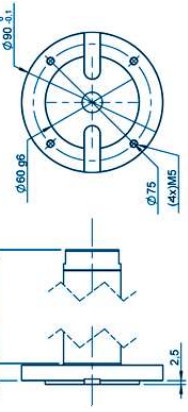

GROUP I SHAFT CL1 - KEYED Ø10

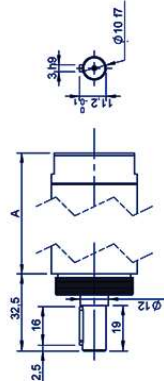

GROUP I SHAFT CL2 - KEYED Ø11 - IEC63B14

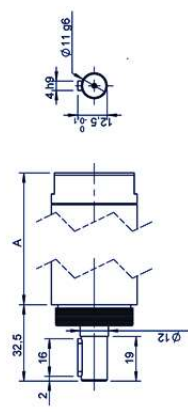

GROUP I SHAFT FI1 - THREADED 3/8" - 24UNF

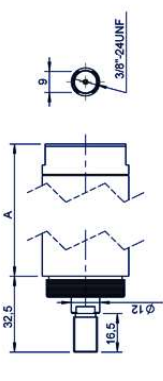

You didn't find your match ?
Contact us !

FLANGES & SHAFTS GROUP II (1/2)

MTE 07 MTS 07

GROUP II FLANGE AA

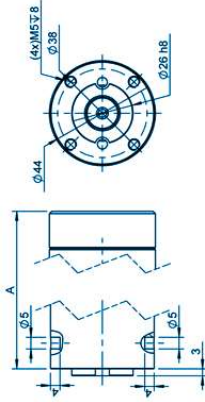

GROUP II FLANGE AB

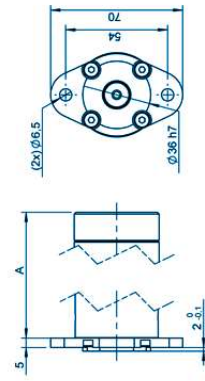

GROUP II FLANGE AC

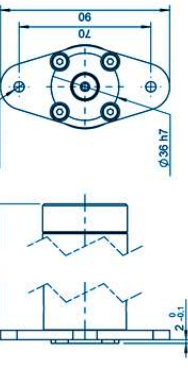

GROUP II FLANGE AD - IEC 71B14

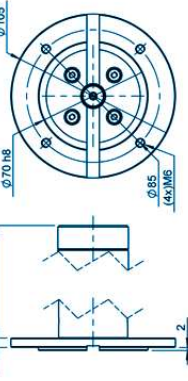

GROUP II FLANGE AE

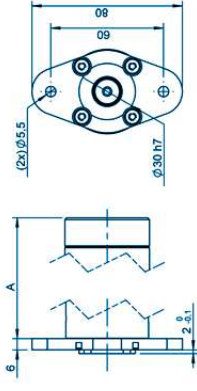

GROUP II SHAFT 001 - KEYED Ø12

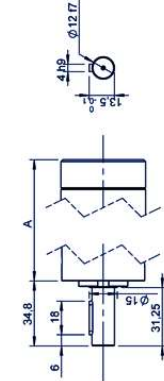

GROUP II SHAFT 004 - KEYED Ø10

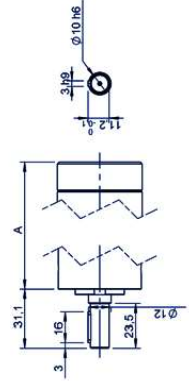

GROUP II SHAFT 006 - KEYED Ø11

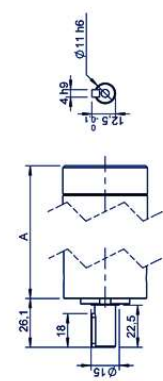

SHAFTS **GROUP II** (2/2)

MTE 07 MTS 07

GROUP II SHAFT S01 - KEYED Ø14 - IEC 71B14

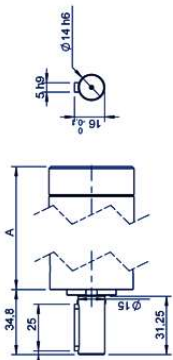

You didn't find your match ?
Contact us !

FLANGES & SHAFTS **GROUP III**

XTE 08 XTE 10 XTE 20 XTE 25

GROUP III FLANGE AB - IEC 80B14

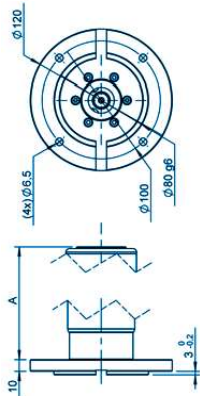

GROUP III FLANGE AA

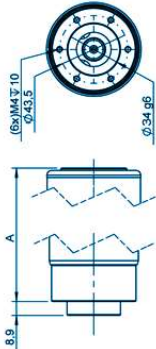

GROUP III FLANGE B

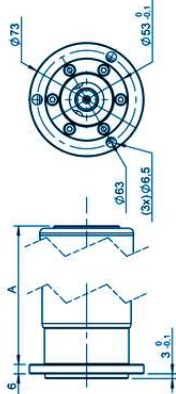

GROUP III FLANGE FJ - IEC 71B14

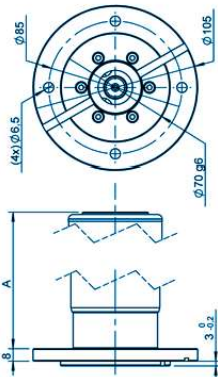

GROUP III SHAFT 001 - KEYED Ø19 - IEC 80B14

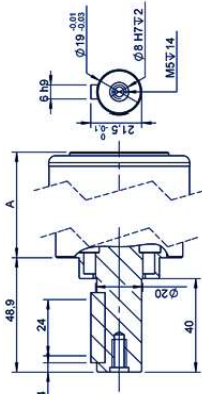

GROUP III SHAFT C25 - KEYED Ø14 - IEC 71B14

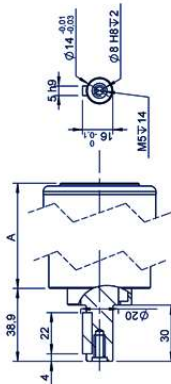

You didn't find your match ?
Contact us !

FLANGES **GROUP IV** (1/3)

GROUP IV FLANGE AB - IEC43B14

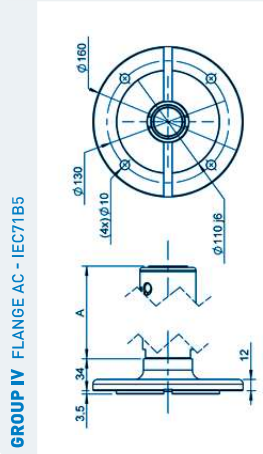
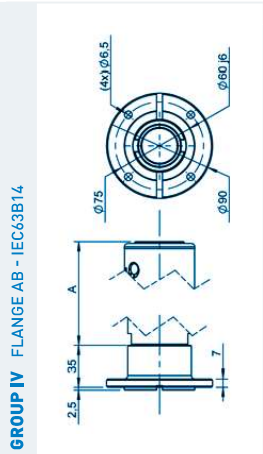

FLANGES **GROUP IV** (2/3)

GROUP IV FLANGE F

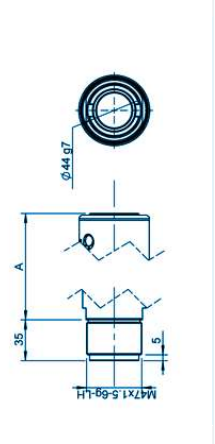

GROUP IV FLANGE FH

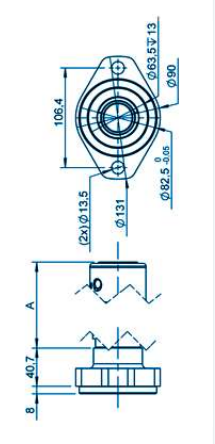

GROUP IV FLANGE AF

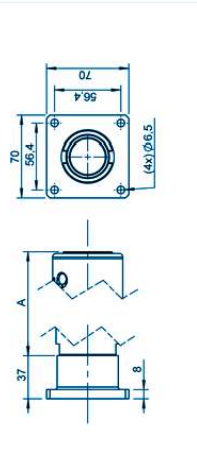

GROUP IV FLANGE AH

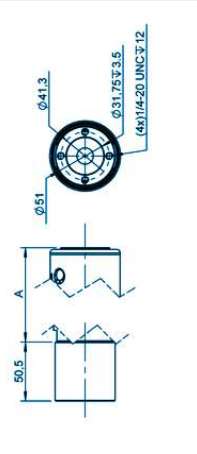

GROUP IV FLANGE FJ - IEC80B14

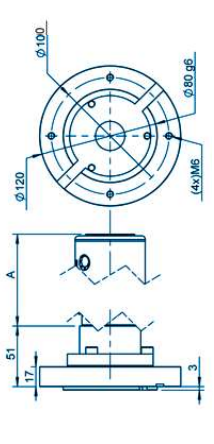

GROUP IV FLANGE J

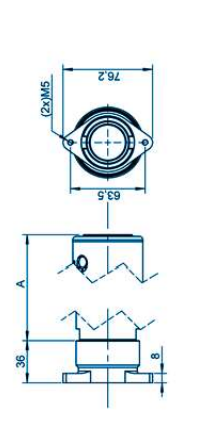

GROUP IV FLANGE AS

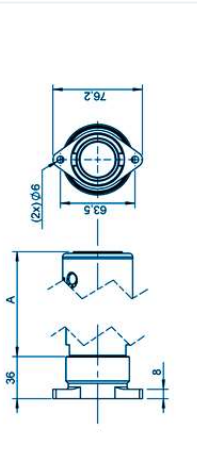

GROUP IV FLANGE AX - ARP

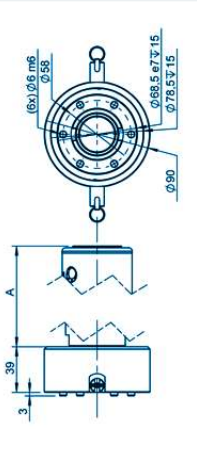

GROUP IV FLANGE L

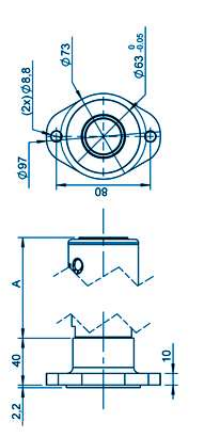

GROUP IV FLANGE M

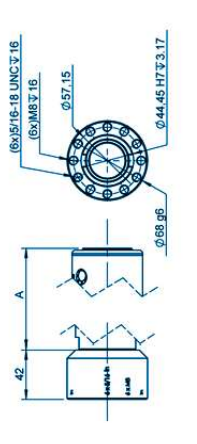

GROUP IV FLANGE B

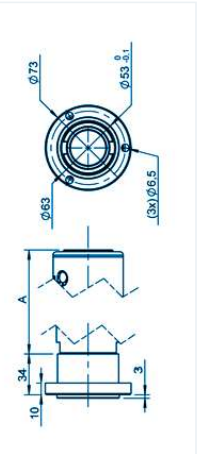

GROUP IV FLANGE B0

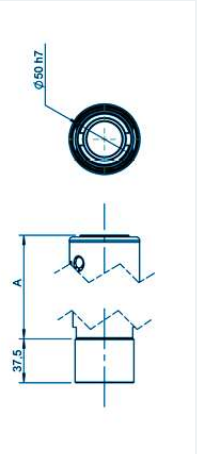

GROUP IV FLANGE N

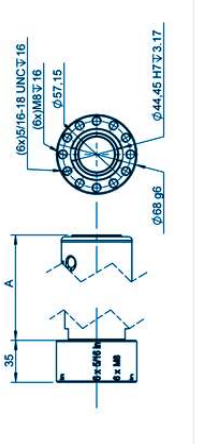

GROUP IV FLANGE Q

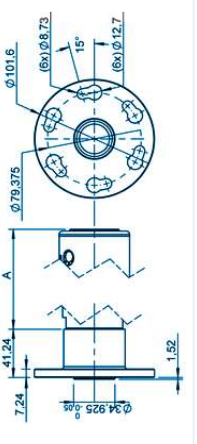

FLANGES **GROUP IV** (3/3)

SHAFTS **GROUP IV** (1/3)

SHAFTS **GROUP IV** (2/3)

GROUP IV FLANGER R - IEC71B14

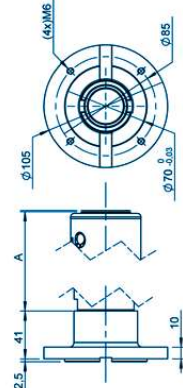

GROUP IV FLANGE S

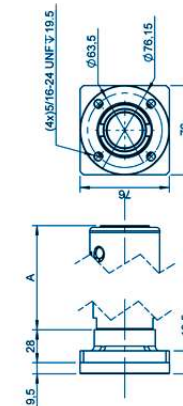

GROUP IV FLANGE U

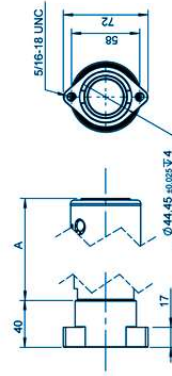

GROUP IV FLANGE V

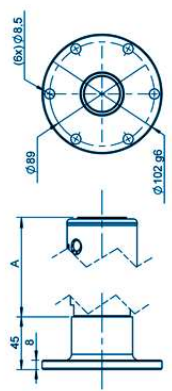

GROUP IV FLANGE W - IEC80B5

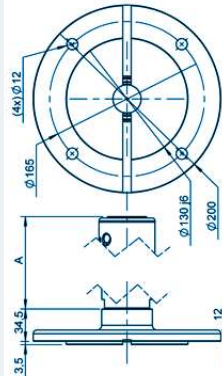

GROUP IV FLANGE Y

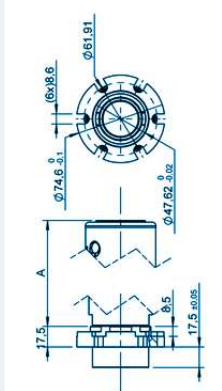

GROUP IV FLANGE Z

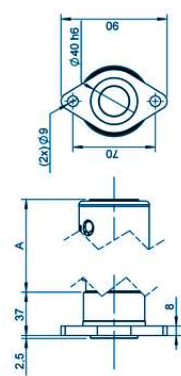

You didn't find
your match ?
Contact us !

GROUP IV SHAFT 007 - KEYED Ø1"

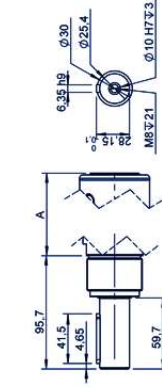

GROUP IV SHAFT 019 - SPLINED ARP

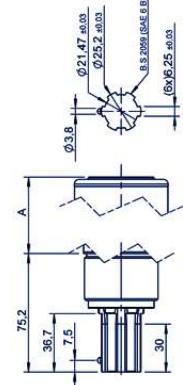

GROUP IV SHAFT C11 - KEYED Ø14 - IEC71B14

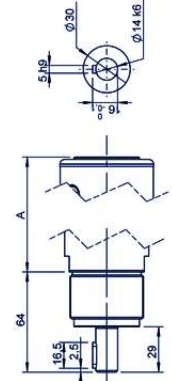

GROUP IV SHAFT C12 - KEYED Ø19 - IEC80B5 - IEC80B14

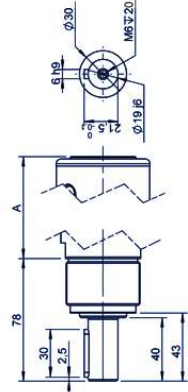

GROUP IV SHAFT C15 - KEYED Ø5/8"

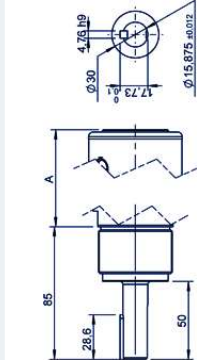

GROUP IV SHAFT C16 - SQUARE Ø5/8"

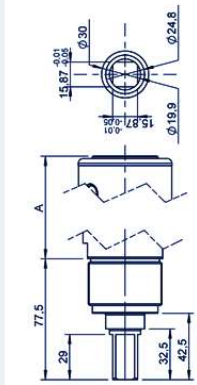

GROUP IV SHAFT C19 - KEYED Ø11 - IEC43B14

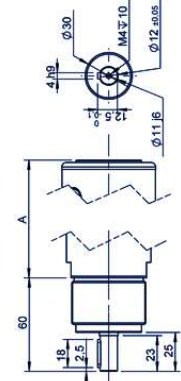

GROUP IV SHAFT CA1 - SQUARE Ø1/2"

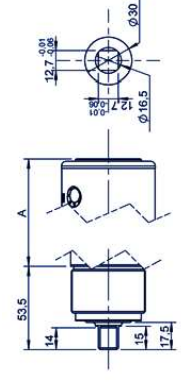

SHAFTS **GROUP IV** (2/3)

SHAFTS **GROUP IV** (3/3)

- XTH 05
- XTH 07
- XTH 08
- XTH 10
- XTH 10
- XTH 10
- XTH 20
- XTH 25

GROUP IV SHAFT CL1 - KEYED Ø1/2"

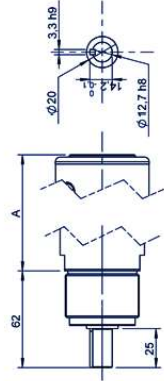

GROUP IV SHAFT CL2 - KEYED Ø3/4"

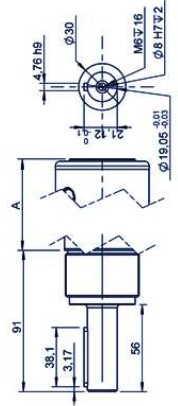

GROUP IV SHAFT CL6 - KEYED Ø16

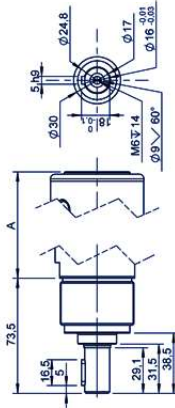

GROUP IV SHAFT CL9 - KEYED Ø12

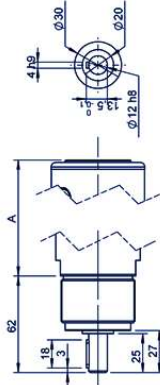

GROUP IV SHAFT CNC - SPLINED SHORT

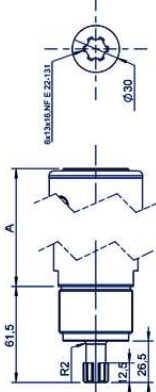

GROUP IV SHAFT CNL - SPLINED LONG

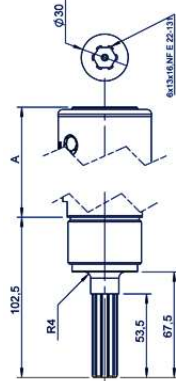

GROUP IV SHAFT CONICAL B12

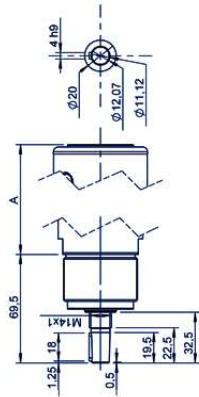

GROUP IV SHAFT CONICAL B16

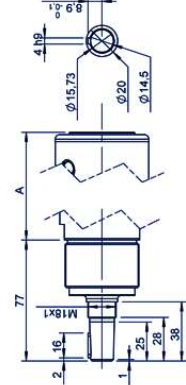

GROUP IV SHAFT F11 - THREADED Ø1/2"

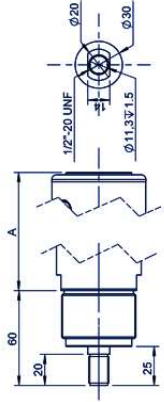

You didn't find
your match ?
Contact us !

FLANGES & SHAFTS **GROUP V**

XTE 30

GROUP V FLANGE AA

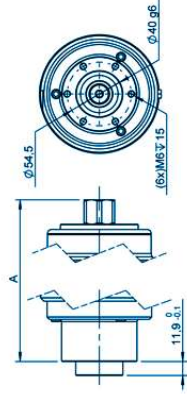

GROUP V FLANGE AB - IEC 80B5 - IEC 90B5

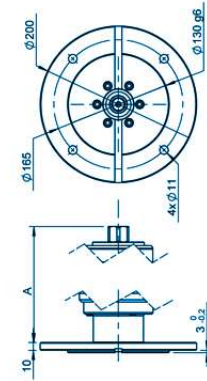

GROUP V FLANGE AC - IEC 80B14

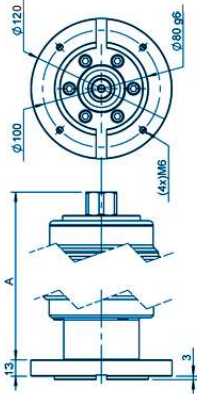

GROUP V FLANGE B

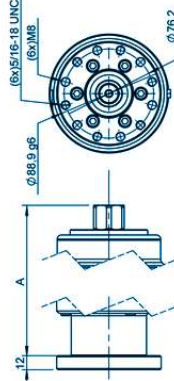

GROUP V SHAFT 001 - KEYED Ø19 - IEC 80B14 - IEC80B5

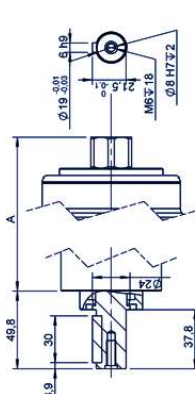

GROUP V SHAFT 002 - KEYED Ø14

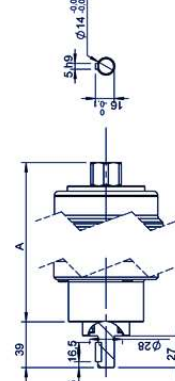

GROUP V SHAFT CL6 - KEYED Ø24 - IEC 90B5

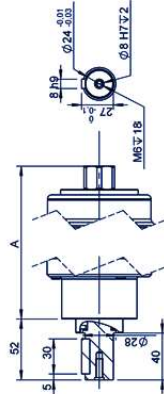

You didn't find your match ?

Contact us !

FLANGES **GROUP VI**

XTZ 08 XTZ 10 XTZ 20 XTZ 25 XTS 30

GROUP VI FLANGE AA

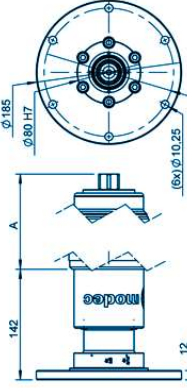

GROUP VI FLANGE AB - IEC80B14

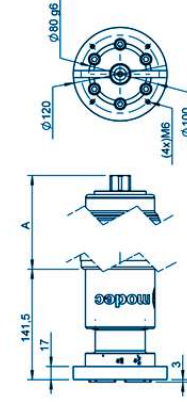

GROUP VI FLANGE AG - IEC80B5

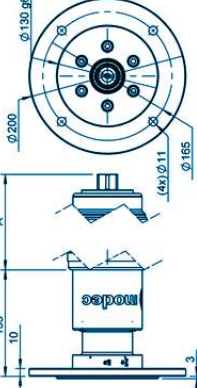

GROUP VI FLANGE AI WITH SHAFT CNW

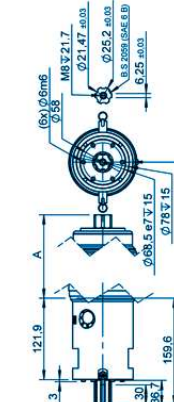

GROUP VI FLANGE AL

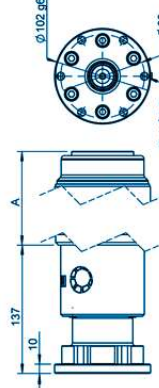

GROUP VI FLANGE B

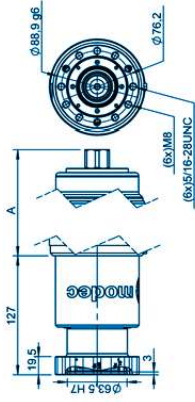

GROUP VI FLANGE H

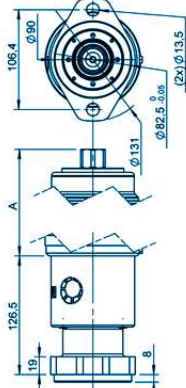

You didn't find your match ?

Contact us !

SHAFTS **GROUP VI**

- XITZ 08
- XITZ 10
- XITZ 20
- XITZ 25
- XITZ 30

GROUP VI SHAFT 003 - KEYED Ø19 - IEC 80B14 - IEC 80B5

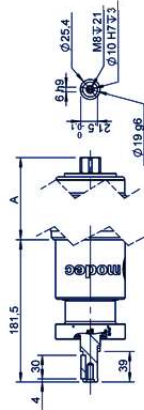

GROUP VI SHAFT CA1 - SQUARE 3/4"

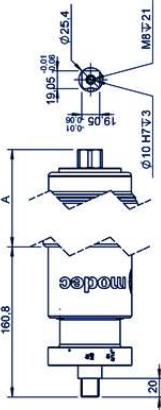

GROUP VI SHAFT CL2 - KEYED Ø11"

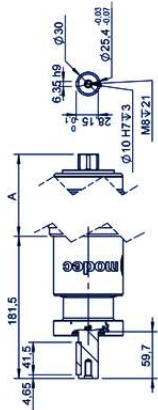

GROUP VI SHAFT CL4 - KEYED Ø25

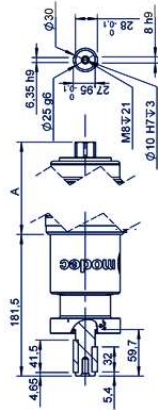

You didn't find
your match ?

Contact us !

FLANGES **GROUP VII**

- XRH 05
- XRH 07
- XRH 08
- XRH 10
- XRH 20
- XRH 25

GROUP VII FLANGE AG WITH SHAFT 013

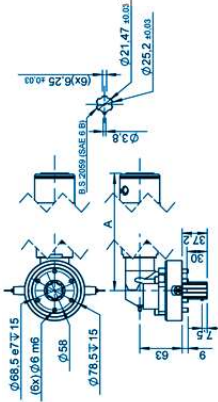

GROUP VII FLANGE AF

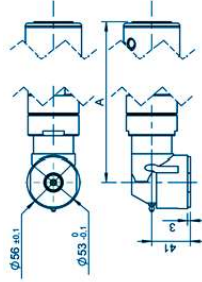

GROUP VII FLANGE E

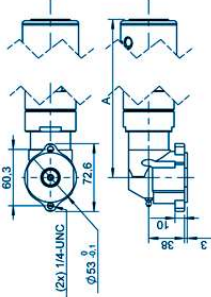

GROUP VII FLANGE B

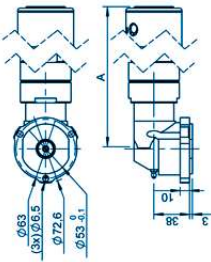

GROUP VII FLANGE Q

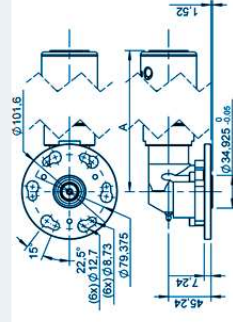

GROUP VII FLANGE M

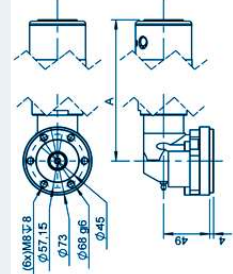

You didn't find
your match ?

Contact us !

SHAFTS **GROUP VII** (1/2)

XRH 05 | XRH 07 | XRS 08 | XRS 10 | XRS 20 | XRS 25

GROUP VII SHAFT 021 - KEYED Ø14

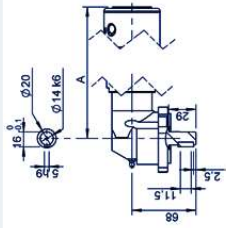

GROUP VII SHAFT C12 - KEYED Ø19

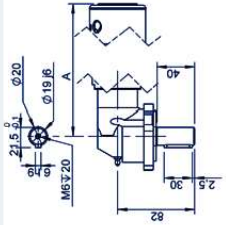

GROUP VII SHAFT C13 - KEYED Ø12

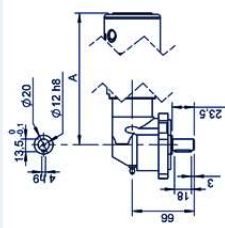

GROUP VII SHAFT C14 - KEYED Ø5/8"

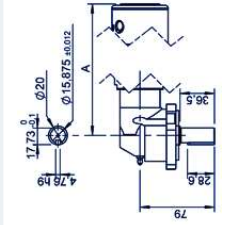

GROUP VII SHAFT CA1 - SQUARE 1/2"

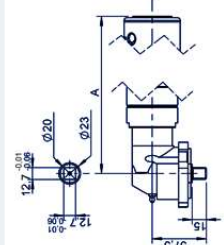

GROUP VII SHAFT CL1 - KEYED Ø1/2"

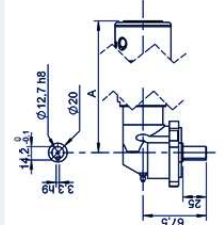

GROUP VII SHAFT CL2 - KEYED Ø3/4"

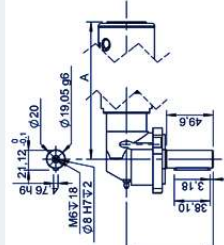

GROUP VII SHAFT CL6 - KEYED Ø16

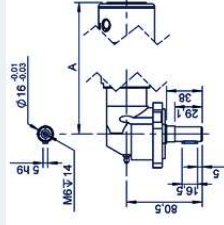

SHAFTS **GROUP VII** (2/2)

XRH 05 | XRH 07 | XRS 08 | XRS 10 | XRS 20 | XRS 25

GROUP VII SHAFT F11 - THREADED Ø1/2"

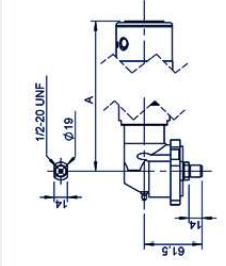

You didn't find your match ?
Contact us !

FLANGES **GROUP VIII**

GROUP VIII FLANGE AA

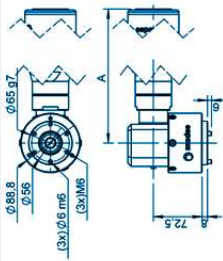

GROUP VIII FLANGE AB

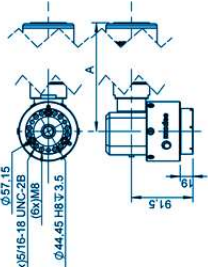

GROUP VIII FLANGE AC

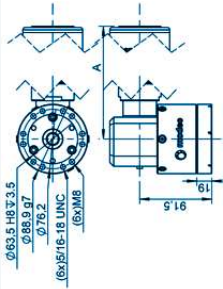

GROUP VIII FLANGE AD

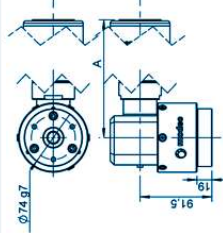

GROUP VIII FLANGE AE

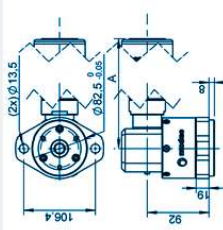

GROUP VIII FLANGE Q

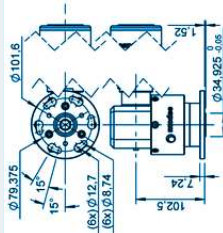

SHAFTS **GROUP VIII**

GROUP VIII SHAFT 001 - KEYED Ø1"

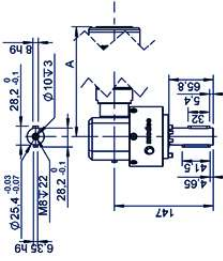

GROUP VIII SHAFT 002 - KEYED Ø3/4"

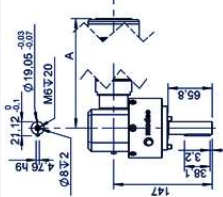

GROUP VIII SHAFT 003 - KEYED Ø25

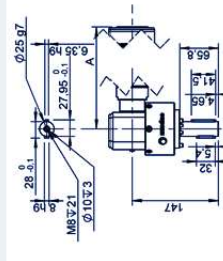

GROUP VIII SHAFT 004 - SQUARE 3/4"

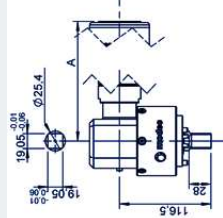

GROUP VIII SHAFT 005 - SQUARE 1/2" LONG

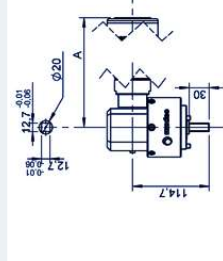

GROUP VIII SHAFT CA1 - SQUARE 1/2" SHORT

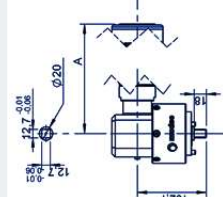

You didn't find your match ?
Contact us !

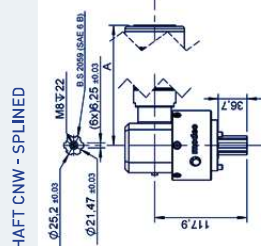

GROUP VIII SHAFT CNW - SPLINED

You didn't find your match ?
Contact us !

FLANGES & SHAFTS GROUP IX

XRZ 08 XRZ 10 XRZ 20 XRZ 25 XRS 30

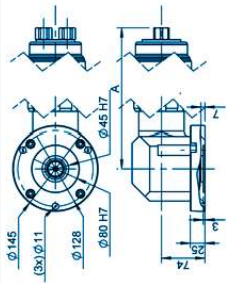
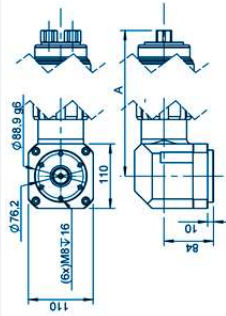
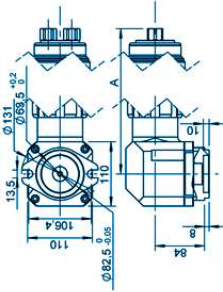
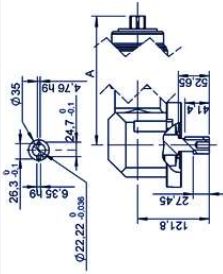
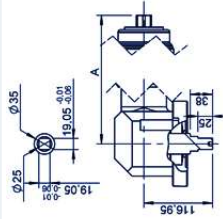
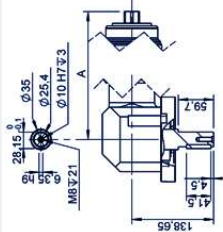
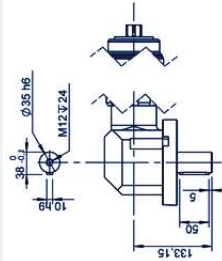
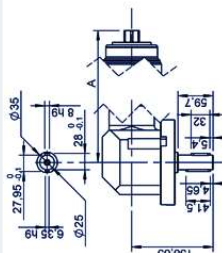
GROUP IX FLANGE A

GROUP IX FLANGE B

GROUP IX FLANGE H

GROUP IX SHAFT 001 - KEYED 07/8"

GROUP IX SHAFT 003 - KEYED 03/4"

GROUP IX SHAFT CL2 - KEYED 01"

GROUP IX SHAFT CL3 - KEYED 035

GROUP IX SHAFT CL4 - KEYED 025

 You didn't find
your match ?

Contact us !

OPTIONS & ACCESSORIES

Modec offers a complete range of options and accessories required for an optimal performance of air motors and solutions.

Options are built into motors during manufacturing :

- Exhaust collectors
- ATEX certification
- Left/Right trigger [for reversible air motors only]
- « No lube kit » for oil free motors
- « Kit start » to ensure immediate start of the motor, even in difficult conditions
- Integrated speed control
- Stainless steel casing

Options are identified with the two last digits of the commercial reference. You will find on each product file a table indicating available options.

OPTIONS AVAILABLE FOR THIS MOTOR	01	02	03	09	10	11	12	13	14
Collected exhaust									
ATEX certification									
Left/Right switch*									
Lubrication free									
Kit start									
Speed control**									
Inox									

*ATEX certification only **Non reversible motors only

OPTIONS EXHAUST COLLECTORS

Exhaust collectors are to be mounted on the 10, 20, 25 & 30 series (other series air motors are always collected). They enable to collect exhaust in order to drive it towards a filter or silencer, or simply to bring it away from the working place. Using an exhaust collector with a silencer may slightly reduce performance (30 series) or significantly increase it (10 and 20 series). See table p.181.

It will also increase the motor maximum diameter (see an example below for the "10" series).



Exhaust collectors can also be assembled on motors after manufacturing, as accessories (see chapter 'Accessories' hereafter).

I ATEX CERTIFICATION

All modec air motors can be certified ATEX on request.

See chapter 7. Certifications in the General information section (page 18)



ATEX II 2 G D
Ex h IIC T4...T4 Gb
Ex h IIC T80°C...T135 Db

LEFT/RIGHT TRIGGER

Available for reversible air motors only, this option allows to control the rotation direction directly on the motor with a simple trigger. No need for 5/3 distribution valve and separate air supply hoses. Very convenient for motors installed on machines where a manual rotation change is required.



LUBRICATION FREE

Oil free motors are specially designed to work without adding oil in the air supply. This can be required in specific applications (clean rooms for example).

In that case, air quality, dryness and cleanliness is even more critical to a good functioning and lifespan of the motor. One shall use adequate filtering units and check filters regularly. No lube air motors should not be used unloaded at free speed. When motors are not in use, make sure that they are stored in a dry, clean and ventilated environment.

<< KIT START >>

This option is typically required for applications where the motor is not frequently used and where it is important that motors will start immediately even after a long idle period. The kit start ensures that the vanes will always be out of the rotor notches and consequently that the motor will immediately start up when air comes in.



STAINLESS STEEL MOTORS

Available for most of our models, that option increases our motors robustness and resistance to wet and corrosive environments.



INTEGRATED SPEED CONTROL

The integrated speed control system enables to adjust the output shaft rotation speed simply by rotating the exhaust silencer. No need for external air flow regulator. It is a simple and efficient way to control speed. Available for « 10 » and « 20 » series non reversible air motors.

ACCESSORIES FILTERING, PRESSURE REGULATION AND LUBRICATION UNITS (FRL)

The Filtering, pressure Regulation and Lubrication unit (FRL) is a mandatory element for a good air motor functioning, performance, service life and control. It ensures fluid (compressed air or inert gas) filtering, drying and lubrication so that the motor will be fed with a « clean » gas. It also controls the motor performances through air pressure. The FRL unit should be installed less than 5 m upstream from the motor and should be properly dimensioned so that the flow is consistent with the motor's consumption. Make sure that pipes and fittings are also large enough for the airflow required.



Reference	AC106	AC107	AC108
Max inlet pressure	16 bars	16 bars	16 bars
Pressure gauge	0 / 10 bars	0 / 10 bars	0 / 10 bars
Controlled pressure	0.5 / 8 bars	0.5 / 8 bars	0.5 / 8 bars
Ambient temperature	-10°C / +50°C	-10°C / +50°C	-10°C / +50°C
Oil bowl capacity	40 cm ³	80 cm ³	181 cm ³
Filtration	5 µm	5 µm	5 µm
Purge system	Semi-auto	Semi-auto	Semi-auto
Connection	G 1/4	G 1/4	G 1/4
Dimensions (A x B x C)	240 x 145 x 100 mm	271 x 167 x 112 mm	342 x 210 x 142 mm
Weight (empty)	1,5 kg	2,2 kg	3,85 kg

modec offers a complete range of compact and sturdy FRL, adapted to industrial environment and easy to connect. Self-relieving regulator. Lubrication with selective oil fog. Metal bowl with polypropylene oil level viewing window. Automatic oil refilling pressurized system. Recommended oil type : MODOC CO-16 oil (see hereafter)

SAFETY AIR TREATMENT BOX (SAT BOX)

Safety

The Safety Air Treatment Box (SAT Box) is a safety device designed to protect people & material against damages and accidents. Placed upstream from the pneumatic actuators (motors, pistons or any portable pneumatic tools) the SAT Box provides numerous important safety features:

- **Emergency kill switch**
- **Key safety lock (optional)**
- **Downstream automatic air-bleed**
- **Automatic switch off when air pressure drop is detected**



As soon as the emergency kill switch is hit, the SAT Box ensures an instantaneous air bleed in the downstream circuit so that no residual energy may create an accidental motion after the stop.

In case air pressure drops below 2 bars, the SAT Box automatically shuts off and bleeds downstream circuit. One needs to press the "start" button again to restart flow. This prevents any unexpected start in case one person stops and restarts the compressor without information to the user.

All these safety features are energized by air pressure, without any other source of energy required. This makes it possible to have it ATEX certified on request.

Air treatment

The SAT Box also contains a FRL unit (Filtration, pressure Regulation and Filtration). Refer to the FRL description above.

Easy control

The SAT Box can be equipped as an option with several remote control devices for an easy and efficient use (pedal, handle or emergency kill switch placed close to the operator).

Reference	AC118	AC126
Motors series	05, 07, 08, 10, 20	25, 30
FRL type	AC107	AC108
Emergency kill switch	Yes	Yes
Automatic air bleed	Yes	Yes
Pressure gauge	0-10 bars	0-10 bars
Filtration	5 µm	5 µm
Oil bowl capacity	80 cm ³	181 cm ³
Committed pressure	2-8 bars	2-8 bars
Ambient temperature	-10°C/+50°C	-10°C/+50°C
Connection	In G 1/2 - Out G 1/4	In G 1/2 - Out G 1/4
Dimensions (mm) A x B x C	277 x 216 x 286 mm/304 x 216 x 346 mm	
Weight (empty)	7.6 kg	11.7 kg
Option :		
Pedal remote control	AC119	AC127
Handle remote control	AC120	AC128
Remote Emergency Kill Switch	AC125	AC129
Remote pedal and FRS	AC121	AC130
Remote Handle and FRS	AC122	AC131

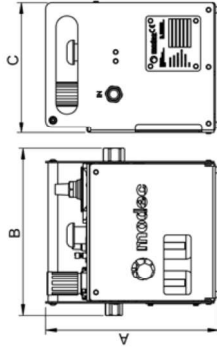

All components are protected with a stable and sturdy metallic box designed for a heavy duty workdays and workbenches use.



PNEUMATIC OIL modec CO-16

Lubricating oil specially selected for modec air motors and actuators

- Synthetic oil**
- : 22cSt
 - Kinematic viscosity at 40°C : 145
 - Viscosity index : 824kg/m³
 - Voluminal mass : +210°C
 - Flash point : -55°C
 - Pour point : -55°C/130°C
 - Temperature of use : AC149

MOTOR CONTROL HANDLES

Safety handles

Safety handles change your motor into a portable tool with a manual "on/off" control. It guarantees operator's safety thanks to a specific trigger that prevents any accidental start, and an automatic return system that ensures a complete stop of the air flow as soon as the handle is released.

This handle exist in different models depending on the motor it is designed for (power, reversible or non-reversible). It is delivered with the interface parts required for an easy assembly to the motor.

Progressive control handle

The progressive control handle enables an efficient, ergonomic and safe control of the motor air supply, and consequently of the motor speed. It is particularly suited to applications requiring constant speed control and adaptation.

Safe : The progressive control handle shuts off automatically as soon as the operator releases it.

Ergonomic : It works like a motorbike throttle grip, it is intuitive and smooth.

Versatile : It can be assembled on the "08", "10", "20", "25" & "30" series, with or without safety handle.

Left / Right switch

This simple "Left / Right" (or "CCW / CW") lever placed in the back of the motor allows a direct rotation direction control. No need for pipes, fittings and 3/3 distribution valve anymore.



Series	Safety handles	Progressive control handles	Left / Right switch
08 RT	AC415	AC417	N/A
08 RV	AC416	AC418	N/A
10 XT	AC406	AC408	AC429
10 RT	AC404	AC406	N/A
20 RT	AC403	AC405	AC430
20 RV	AC409	AC411	N/A
25 RT	AC412	AC414	AC431
30 RT	AC412	AC414	AC432
30 RV	AC412	AC414	N/A
Assembly on a safety handle	N/A	AC410	AC432
SAT Box remote control handle	AC405	N/A	N/A

FILTERS & SILENCERS

1 • STANDARD EXHAUST SILENCERS

Extremely compact, these metallic or plastic silencers significantly reduce exhaust noise with a minimal impact on the motor overall size.

They also prevent any external parts or impurities from getting inside the motor through exhaust vent.

IMPORTANT : Make sure that the silencer maximum acceptable flow is consistent with the maximal air output flow of the motor in order to avoid impact on the motor performances (torque & speed).

• METALLIC SILENCERS

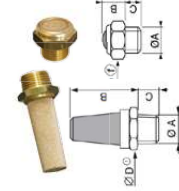

Reference	AC169	AC168	AC180	AC181	AC164	AC182
Operating pressure	p → 10 bars					
Ambient temperature	-10°C → +80°C					
Connection (DA)	G 1/4	G 1/4	G 1/4	G 1/4	G 1/2	G 1/4
Dimensions (B x C x ØD) (mm)	10 x 6 x 13	22,4 x 5,6 x 13	41,6 x 8,4 x 16	49,2 x 8,8 x 24	54,6 x 11,4 x 27	82,3 x 12,7 x 36
Weight	6 g	10 g	30 g	30 g	70 g	300 g
Suitable for motors	Refer to table p.101					

Alu metallic silencer (AC169): Stainless steel body, Nickel plated brass connection piece.

Other metallic silencers : Pnious bronze body, brass connection piece.

• PLASTIC SILENCERS

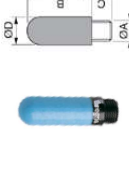

Reference	AC166	AC150	AC183	AC184	AC182	AC153
Operating pressure	0 → 10 bars					
Ambient temperature	-10°C → +80°C					
Connection (DA)	G 1/4	G 1/4	G 1/4	G 1/4	G 1/4	G 1/4
Dimensions (B x C x ØD) (mm)	27,6 x 7,3	34,4 x 7,15	55 x 11 x 18	62,4 x 12 x 23	113 x 16 x 38	141 x 20 x 43
Weight	2 g	4 g	6 g	10 g	40 g	65 g
Suitable for motors	Refer to table p.101					

Polyethylene body, technical polymer connection piece.

2. HEAVY DUTY EXHAUST SILENCERS

These silencers softly exhaust air and disperse it over a 360° pattern. It won't clog up even in harsh environment. Made of a corrosion-resistant metal, it can withstand shock and continuous, heavy duty use under many conditions.



Reference	AC167	AC154	AC155	AC158	AC156	AC157
Operating pressure	0 → 14 bars					
Ambient temperature	-20°C → +110°C					
Connection	6 1/4"	6 1/4"	6 1/4"	6 1/4"	6 1/4"	6 1/4"
Dimensions (A x B x C) (mm)	35 x 31 x 11	44 x 39 x 14	57 x 51 x 18	69 x 61 x 22	80 x 71 x 27	99 x 88 x 33
Weight	9 g	23 g	36 g	68 g	122 g	227 g
Suitable for motors	Refer to table p.181					

Zinc-plated steel diaphragm body, brass sieve

3. HIGH FLOW EXHAUST MUFFLER

High flow exhaust muffler generate very minimal pressure drop while significantly reducing noise. They definitively are the best solution in terms of "Noise reduction / Pressure drop" ratio.

85% Noise Reduction

94% Flow Factor

Constructed with a unique expansion chamber, completely free of obstruction, exhaust air softly flows to the atmosphere without noise and oil fog, providing a clean, comfortable and productive work environment.

Composed entirely of corrosion-resistant material for long life and maintenance-free performance, units have a hex head, making it easy to attach to exhaust ports. They should be mounted in a protective position, free from excessive vibrations.



Reference	AC158	AC159	AC160
Operating pressure	0 → 10 bars		
Ambient temperature	-40°C → +145°C		
Connection	6 1/2"	6 1/2"	6 1/2"
Dimensions (A x B x C) (mm)	152 x 80	183 x 85	222 x 98
Weight	340	450 g	590 g
Suitable for motors	Refer to table p.181		

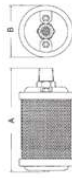

4. EXHAUST FILTERS & SILENCERS

Designed to reduce both exhaust noise level and pollution by eliminating solid particles and oil aerosols, these silencers must be assembled in vertical position (slope : 15° max.).

Pressure drops due to clogging of cartridge must not exceed 0.5 bar, in which case replace cartridge.

Condensate are automatically drained once they exceed a given level. The drain may however be activated manually by turning the knurled switch (1/4 turn).

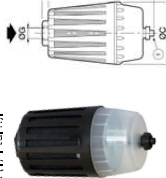

Aluminum housing and polypropylene (PP) bowl.
Filter element : fibrous texture bonded by a plastic resin.
Sealed by a rubber gasket.

Reference	AC165	AC161	AC162
Operating pressure	0 → 16 bars		
Ambient temperature	-5°C → +50°C		
Connection (Ø)	6 1/2"	6 1/2"	6 1/2"
Dimensions (A x B x C) (mm)	12 x 180 x 90	12 x 180 x 90	15 x 250 x 110
Weight	600	560 g	1070 g
Suitable for motors	Refer to table p.181		

1. AIRFLOW CONTROLLERS

1. SPEED CONTROL MUFFLERS

The Polyethylene Speed Control Muffler is designed to adjust the pressure gap between air input and output of the motor by controlling the low end of the flow range. In that way, input pressure remains unchanged and there is no impact on the loaded starting torque, although the torque and speed at max power are reduced. It also reduces decibel levels to an OSHA approved level. It can be used with air or filtered inert gases, lubricated or not.

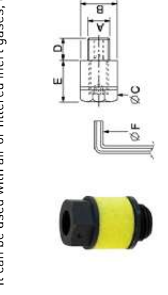

Its body is made of highly versatile and cost-effective nylon. The adjusting screw is made of high tensile steel and is coated with electroplated zinc.

Reference	AC170	AC171	AC172	AC173
Operating pressure	0 → 10 bars			
Ambient temperature	-10°C → + 80°C			
Connection (Ø)	6 1/4"	6 1/4"	6 1/4"	6 1/4"
Dimensions (B x C D x E x F) (mm)	15 x 13 x 6 x 22 x 4	18 x 15 x 7 x 24 x 20 x 8 x 30 x 6	24 x 20 x 8 x 30 x 6	30 x 23 x 10 x 40 x 6
Weight	5g	10g	30g	50g
Suitable for motors	« 05 »	« 07 »	« 08 »	« 10 » « 20 » « 25 » « 30 »

2. IN-LINE FLOW REGULATORS

In-line flow regulators control the motor air supply flow and consequently its rotation speed. They are particularly compact and easy to install either on the air motor inlet port or on the air supply pipe. They can also be used on the exhaust port.



Aluminum body
In-line flow regulators come with appropriate fittings for assembly on all motors inlet ports.

Reference	AC186	AC187	AC188	AC189	AC190	AC191	AC192
Operating pressure	0 → 17 bars						
Ambient temperature	-40°C → +120°C						
Air motor inlet connection	6 1/4"	6 1/4"	6 1/4"	6 1/4"	6 1/4"	6 1/4"	6 1/4"
Air supply connection	6 1/4"	6 1/4"	6 1/4"	6 1/4"	6 1/4"	6 1/4"	6 1/4"
Dimension (A x B)	50,8 x 20,6	64,8 x 26,9	73,4 x 31,8	73,4 x 31,8	82,6 x 41,4	82,6 x 41,4	82,6 x 41,4
Weight	5g	10g	15g	15g	25g	25g	25g
Suitable for motors	"05"	"07"	"08"	"10"	"10"	"10"	"25"

MAINTENANCE KITS



Maintenance kits contain two sets of parts required for one regular motor maintenance (refer to chapter 6 "Air motors storage & maintenance" in the first part of this catalogue). With one kit, you can perform two maintenance operations.

Maintenance kits come with an instruction notice and video tutorials are available on our **You Tube channel**.

Reference	05	07	08	10	20	25	30
Standard	AC300	AC301	AC302	XT : AC303 RV : AC308	AC304	AC305	AC306
Lube free	AC310	AC311	AC312	XT : AC313 RV : AC318	AC314	AC315	AC316
Kit start	AC320	AC321	AC322	XT : AC323 RV : AC328	AC324	AC325	AC326

5. AIR MOTORS / SILENCERS CORRESPONDENCE TABLE AND POWER IMPACT

	05	07	08	10XT	10RV	20 XT	20 RV	25	30
Size	Exhaust: G1/8 Inlet: G1/8	Exhaust: G1/4 Inlet: G1/8	Exhaust: G3/8 Inlet: G3/8	Exhaust: G3/4 Inlet: G3/4	Exhaust: G3/4 Inlet: G3/4	Exhaust: G3/4 Inlet: G3/4	Exhaust: G3/4 Inlet: G3/4	Exhaust: G3/4 Inlet: G3/4	Exhaust: G3/4 Inlet: G3/4
Power impact	AC166: -14% AC168: -10% AC169: -10%	AC164: -14% AC165: -10% AC167: -10%	AC163: -10% AC164: -10% AC165: -10%	AC162: -10% AC163: -10% AC164: -10%	AC162: -10% AC163: -10% AC164: -10%	AC162: -10% AC163: -10% AC164: -10%	AC162: -10% AC163: -10% AC164: -10%	AC162: -10% AC163: -10% AC164: -10%	AC162: -10% AC163: -10% AC164: -10%
Reference	AC168 AC169	AC168 AC169	AC168 AC169	AC168 AC169	AC168 AC169	AC168 AC169	AC168 AC169	AC168 AC169	AC168 AC169
Power impact	-14%	-10%	-10%	-10%	-10%	-10%	-10%	-10%	-10%
Reference	AC167 AC168 AC169	AC167 AC168 AC169	AC167 AC168 AC169	AC167 AC168 AC169	AC167 AC168 AC169	AC167 AC168 AC169	AC167 AC168 AC169	AC167 AC168 AC169	AC167 AC168 AC169
Power impact	-14%	-10%	-10%	-10%	-10%	-10%	-10%	-10%	-10%
Reference	AC167 AC168 AC169	AC167 AC168 AC169	AC167 AC168 AC169	AC167 AC168 AC169	AC167 AC168 AC169	AC167 AC168 AC169	AC167 AC168 AC169	AC167 AC168 AC169	AC167 AC168 AC169
Power impact	-14%	-10%	-10%	-10%	-10%	-10%	-10%	-10%	-10%
Reference	AC167 AC168 AC169	AC167 AC168 AC169	AC167 AC168 AC169	AC167 AC168 AC169	AC167 AC168 AC169	AC167 AC168 AC169	AC167 AC168 AC169	AC167 AC168 AC169	AC167 AC168 AC169
Power impact	-14%	-10%	-10%	-10%	-10%	-10%	-10%	-10%	-10%

EXHAUST COLLECTOR KITS

Exhaust collector kits can be easily assembled on 10, 20, 25 & 30 series motors and allow to use silencers, filters, airflow controllers, or simply a pipe to bring exhaust away from the working place.

Using an exhaust collector with a silencer may slightly reduce performance (30 series) or significantly increase it (10 and 20 series). See table p.180

It will also increase the motor maximum diameter (see table p.176).

Reference	AC340	AC341	AC342	AC343
Diameter (mm)	Ø7	Ø3	Ø3	Ø3
Connection	6 1/4"	6 1/4"	6 1/4"	6 1/4"
Air motor series	10	20	25	30

SPECIAL PRODUCTS & TOOLS

| NUT RUNNERS



All our motors can be used as nut runners by using the stall torque as a maximum torque that can be set by simply adjusting air pressure.

Just refer to the "NR" products type data sheet in each series and families.

NR products type are made of a handle, a motor and a right angle head which make them a perfect, safe and ergonomic bolting tool, with a power range from 400 W ("08" series) to 3200 W ("30" series) and a bolting torque that can reach up to 1000 Nm.

It is important to note that these nut runners cannot be used as precision tools. The accuracy of the torque values indicated is +/-5%.

| TAPPING MACHINES



All our motors can also be used as tapping machines in their NTxxRV type. We have designed a specific range of tapping machines with an appropriate safety handle and rotation control. We have specific shafts designed for tappers.

Refer to the T2500 product data sheet on page 70.

| SPECIAL MOTORS

Flexibility, Expertise and Innovation are our main strengths. We regularly design special motors on customer request for specific applications, and we love that !



Submarine stainless steel air motor

High speed motor for deburring / machining

Special shape & dimension air motor

Air fail brake motor

Whether it is submarine air motors, motors with air fail brakes, torque limiters or special flanges and shafts, we will answer your specific request quickly and precisely. Just ask us!

Don't hesitate to contact us

www.modtec.fr
+33 475 402 715
sales@modtec.fr